

Licensing Sub-Committee

**Thursday 13 December 2012 at 10.00
am**

**To be held at the Town Hall, Pinstone
Street, Sheffield, S1 2HH**

The Press and Public are Welcome to Attend

Membership

**Councillors John Robson (Chair), David Barker and George Lindars-Hammond
Nikki Bond (Reserve)**

PUBLIC ACCESS TO THE MEETING

The Licensing Committee carries out a statutory licensing role, including licensing for taxis and public entertainment.

As a lot of the work of this Committee deals with individual cases, some meetings may not be open to members of the public.

A copy of the agenda and reports is available on the Council's website at www.sheffield.gov.uk. You can also see the reports to be discussed at the meeting if you call at the First Point Reception, Town Hall, Pinstone Street entrance. The Reception is open between 9.00 am and 5.00 pm, Monday to Thursday and between 9.00 am and 4.45 pm. on Friday, or you can ring on telephone no. 2734552.

You may not be allowed to see some reports because they contain confidential information. These items are usually marked * on the agenda.

If you require any further information please contact Harry Clarke on 0114 273 6183 or email harry.clarke@sheffield.gov.uk.

FACILITIES

There are public toilets available, with wheelchair access, on the ground floor of the Town Hall. Induction loop facilities are available in meeting rooms.

Access for people with mobility difficulties can be obtained through the ramp on the side to the main Town Hall entrance.

**LICENSING SUB-COMMITTEE AGENDA
13 DECEMBER 2012**

Order of Business

- 1. Welcome and Housekeeping Arrangements**
- 2. Apologies for Absence**
- 3. Exclusion of Public and Press**
To identify items where resolutions may be moved to exclude the press and public
- 4. Declarations of Interest**
Members to declare any interests they have in the business to be considered at the meeting
- 5. Licensing Act 2003 - Blue Bell Inn, 1 Main Street, Sheffield S12 4LA**
Report of the Chief Licensing Officer

This page is intentionally left blank

ADVICE TO MEMBERS ON DECLARING INTERESTS AT MEETINGS

New standards arrangements were introduced by the Localism Act 2011. The new regime made changes to the way that members' interests are registered and declared.

If you are present at a meeting of the Council, of its executive or any committee of the executive, or of any committee, sub-committee, joint committee, or joint sub-committee of the authority, and you have a **Disclosable Pecuniary Interest** (DPI) relating to any business that will be considered at the meeting, you must not:

- participate in any discussion of the business at the meeting, or if you become aware of your Disclosable Pecuniary Interest during the meeting, participate further in any discussion of the business, or
- participate in any vote or further vote taken on the matter at the meeting.

These prohibitions apply to any form of participation, including speaking as a member of the public.

You **must**:

- leave the room (in accordance with the Members' Code of Conduct)
- make a verbal declaration of the existence and nature of any DPI at any meeting at which you are present at which an item of business which affects or relates to the subject matter of that interest is under consideration, at or before the consideration of the item of business or as soon as the interest becomes apparent.
- declare it to the meeting and notify the Council's Monitoring Officer within 28 days, if the DPI is not already registered.

If you have any of the following pecuniary interests, they are your **disclosable pecuniary interests** under the new national rules. You have a pecuniary interest if you, or your spouse or civil partner, have a pecuniary interest.

- Any employment, office, trade, profession or vocation carried on for profit or gain, which you, or your spouse or civil partner, undertakes.
- Any payment or provision of any other financial benefit (other than from your council or authority) made or provided within the relevant period* in respect of any expenses incurred by you in carrying out duties as a member, or towards your election expenses. This includes any payment or financial benefit from a trade union within the meaning of the Trade Union and Labour Relations (Consolidation) Act 1992.

*The relevant period is the 12 months ending on the day when you tell the Monitoring Officer about your disclosable pecuniary interests.

- Any contract which is made between you, or your spouse or your civil partner (or a body in which you, or your spouse or your civil partner, has a beneficial interest) and your council or authority -
 - under which goods or services are to be provided or works are to be executed; and
 - which has not been fully discharged.
- Any beneficial interest in land which you, or your spouse or your civil partner, have and which is within the area of your council or authority.
- Any licence (alone or jointly with others) which you, or your spouse or your civil partner, holds to occupy land in the area of your council or authority for a month or longer.
- Any tenancy where (to your knowledge) -
 - the landlord is your council or authority; and
 - the tenant is a body in which you, or your spouse or your civil partner, has a beneficial interest.
- Any beneficial interest which you, or your spouse or your civil partner has in securities of a body where -
 - (a) that body (to your knowledge) has a place of business or land in the area of your council or authority; and
 - (b) either
 - the total nominal value of the securities exceeds £25,000 or one hundredth of the total issued share capital of that body; or
 - if the share capital of that body is of more than one class, the total nominal value of the shares of any one class in which you, or your spouse or your civil partner, has a beneficial interest exceeds one hundredth of the total issued share capital of that class.

Under the Council's Code of Conduct, members must act in accordance with the Seven Principles of Public Life (selflessness; integrity; objectivity; accountability; openness; honesty; and leadership), including the principle of honesty, which says that 'holders of public office have a duty to declare any private interests relating to their public duties and to take steps to resolve any conflicts arising in a way that protects the public interest'.

If you attend a meeting at which any item of business is to be considered and you are aware that you have a **personal interest** in the matter which does not amount to a DPI, you must make verbal declaration of the existence and nature of that interest at or before the consideration of the item of business or as soon as the interest becomes apparent. You should leave the room if your continued presence is incompatible with the 7 Principles of Public Life.

You have a personal interest where –

- a decision in relation to that business might reasonably be regarded as affecting the well-being or financial standing (including interests in land and easements over land) of you or a member of your family or a person or an organisation with whom you have a close association to a greater extent than it would affect the majority of the Council Tax payers, ratepayers or inhabitants of the ward or electoral area for which you have been elected or otherwise of the Authority's administrative area, or
- it relates to or is likely to affect any of the interests that are defined as DPs but are in respect of a member of your family (other than a partner) or a person with whom you have a close association.

Guidance on declarations of interest, incorporating regulations published by the Government in relation to Disclosable Pecuniary Interests, has been circulated to you previously, and has been published on the Council's website as a downloadable document at [-http://councillors.sheffield.gov.uk/councillors/register-of-councillors-interests](http://councillors.sheffield.gov.uk/councillors/register-of-councillors-interests)

You should identify any potential interest you may have relating to business to be considered at the meeting. This will help you and anyone that you ask for advice to fully consider all the circumstances before deciding what action you should take.

In certain circumstances the Council may grant a **dispensation** to permit a Member to take part in the business of the Authority even if the member has a Disclosable Pecuniary Interest relating to that business.

To obtain a dispensation, you must write to the Monitoring Officer at least 48 hours before the meeting in question, explaining why a dispensation is sought and desirable, and specifying the period of time for which it is sought. The Monitoring Officer may consult with the Independent Person or the Council's Standards Committee in relation to a request for dispensation.

Further advice can be obtained from Lynne Bird, Director of Legal Services on 0114 2734018 or email lynne.bird@sheffield.gov.uk

This page is intentionally left blank



SHEFFIELD CITY COUNCIL Committee Report

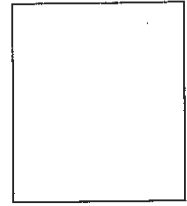

Report of: Chief Licensing Officer, Head of Licensing

Date: 13 December 2012

Subject: Licensing Act 2003

Author of Report: Andy Ruston

Summary: To consider a Premises Licence Application made under the Licensing Act 2003.

Recommendations: That members carefully consider the representations made and take such steps, as the Committee consider necessary for the promotion of the Licensing Objectives.

Background Papers: Attached documents

Category of Report: OPEN

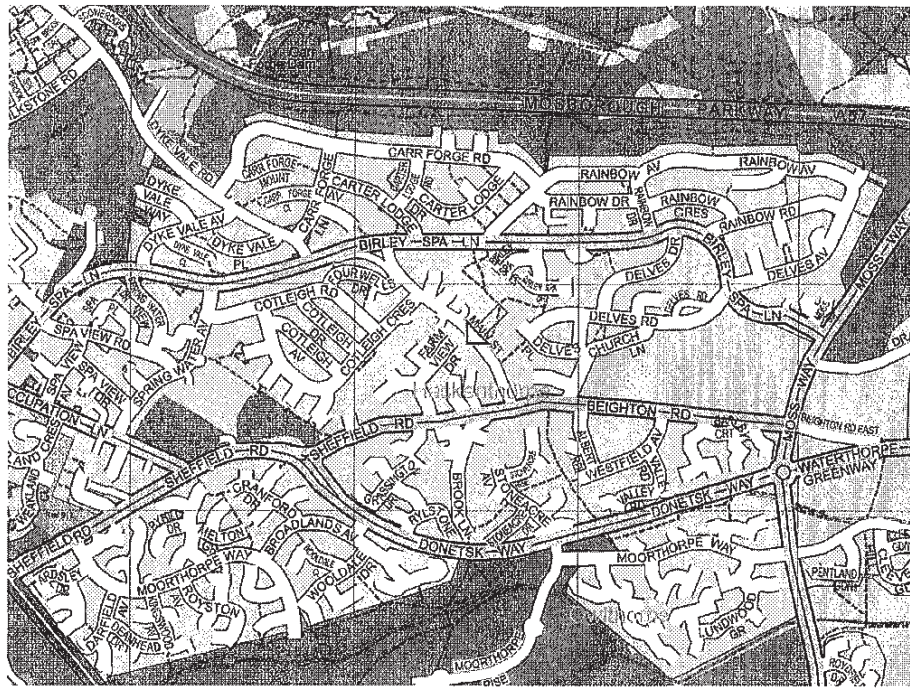

- 6.1 Regulations governing hearings under the Licensing Act 2003 have been made by the Secretary of State.
- 6.2 The Licensing Authority has provided all parties with the information required in the Regulations to the 2003 Act as set out at Appendix 'D'.
- 6.3 Attached at Appendix 'D' is the following: -
- a) a copy of the Notice of Hearing;
 - b) the rights of a party provided in Regulations 15 and 16;
 - c) the consequences if a party does not attend or is not represented at the hearing
 - d) the procedure to be followed at the hearing.

7.0 APPEALS

- 7.1 The Licensing Act 2003 section 181 and Schedule 5 makes provision for appeals to be made by the applicant and those making representations against decisions of the Licensing Authority, to the Magistrates' Court.

8.0 RECOMMENDATIONS

- 8.1 That members carefully consider the representations made and take such steps, as the Committee consider necessary for the promotion of the Licensing Objectives.

9.0 OPTIONS OPEN TO THE COMMITTEE

- 9.1 To grant the premises licence in the terms requested.
- 9.2 To grant the premises licence with conditions.
- 9.3 To reject the whole or part of the application.

Stephen Lonnia
Chief Licensing Officer, Head of Licensing
**Licensing Service, Sheffield City Council, Block C Staniforth Road Depot, Staniforth Road,
Sheffield, S9 3HD.**

Appendix 'A'

Rec. 19760

Chg.
000054
1150

Application for a premises licence to be granted under the Licensing Act 2003

(1)

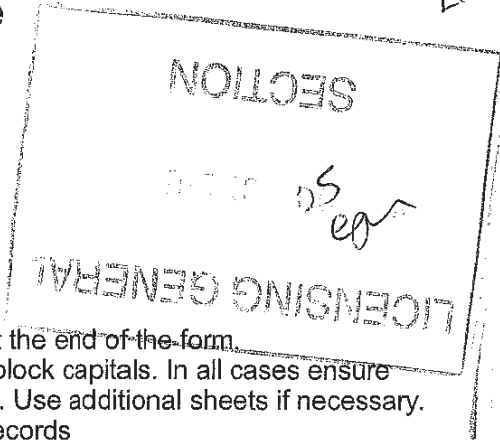

PLEASE READ THE FOLLOWING INSTRUCTIONS FIRST

Before completing this form please read the guidance notes at the end of the form.
If you are completing this form by hand please write legibly in block capitals. In all cases ensure that your answers are inside the boxes and written in black ink. Use additional sheets if necessary. You may wish to keep a copy of the completed form for your records

(2) I/We

HARDIAL MAHAL

apply for a premises licence under section 17

the Licensing Act 2003 for the premises described in Part 1 below (the premises) and I/we are making this application to you as the relevant licensing authority in accordance with section 12 of the Licensing Act 2003

Part 1 - Premises details

Postal address of premises or, if none, Ordnance Survey map reference or description BLUE BELL INN 1 MAIN STREET SHEFFIELD	
Post town SHEFFIELD	Post code S12 4LA

Telephone number at premises(if any)

—

Non-domestic rateable value of premises

£ 17,250

Part 2 - Applicant details

Please state whether you are applying for a premises licence as

Please tick ✓

- a) an individual or individuals*
- b) a person other than an individual*
 - i. as a limited company
 - ii. as a partnership
 - iii. as an unincorporated association; or
 - iv. other (for example a statutory corporation)

- please complete section (A)
- please complete section (B)
- please complete section (B)
- please complete section (B)
- please complete section (B)

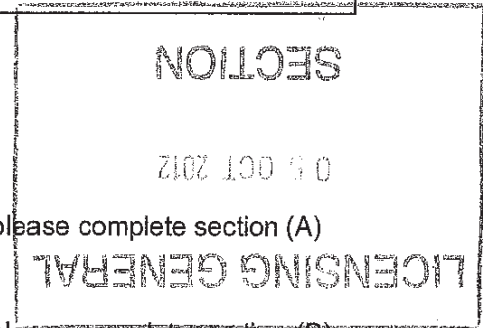

(1) Insert name and address of relevant licensing authority and its reference number (optional)
(2) Insert name(s) of applicant

- c) a recognised club please complete section (B)
- d) a charity please complete section (B)
- e) the proprietor of an educational establishment please complete section (B)
- f) a health service body please complete section (B)
- g) a person who is registered under Part 2 of the Care Standards Act 2000 (c14) in respect of an independent hospital please complete section (B)
- ga) a person who is registered under Chapter 2 of Part 1 of the Health and Social Care Act 2008 in respect of the carrying on of a regulated activity within the meaning of that Part) in an independent hospital in England please complete section (B)
- h) the chief officer of police of a police force in England and Wales please complete section (B)

* If you are applying as a person described in (a) or (b) please confirm:

Please tick ✓ yes

- I am carrying on or proposing to carry on a business which involves the use of the premises for licensable activities; or
- I am making the application pursuant to
 - a statutory function; or
 - a function discharged by virtue of Her Majesty's prerogative

(A) INDIVIDUAL APPLICANTS (fill in as applicable)

Mr Mrs Miss Ms Other title (for example, Rev)

Surname First names

I am 18 years old or over

Please tick ✓ yes

Current postal address if different from premises address

POST OFFICE
GUNHILL
NEW ALLEY

Post town WARWICKSHIRE

Post code CV7 8HB

Daytime contact telephone number

01676 540422

E-mail address (optional)

gunhill2007@hotmail.com

SECOND INDIVIDUAL APPLICANT (if applicable)

Mr Mrs Miss Ms Other title
(for example, Rev)

Surname First names

I am 18 years old or over

Please tick yes

Current postal address if different from premises address 	
Post town	Post code

Daytime contact telephone number

E-mail address (optional)

(B) OTHER APPLICANTS

Please provide name and registered address of applicant in full. Where appropriate please give any registered number. In the case of a partnership or other joint venture (other than a body corporate), please give the name and address of each party concerned.

Name
Address
Registered number (where applicable)
Description of applicant (for example partnership, company, unincorporated association etc.)
Telephone number (if any)
E-mail address (optional)

Part 3 - Operating Schedule

When do you want the premises licences to start?

Day	Month	Year
01	12	2012

If you wish the licence to be valid only for a limited period, when do you want it to end?

Day	Month	Year

Please give a general description of the premises (please read guidance note 1)

THE PREMISES IS CURRENTLY A PUB.(CLOSED)
I REQUIRE THE LICENSE TO OPEN THE PREMISES
AS A CONVENIENCE STORE.

THE ~~PREMISES~~ BUILDING WILL BE CONVERTED INTO
A CONVENIENCE STORE.

If 5,000 or more people are expected to attend the premises at any one time, please state the number expected to attend

--

What licensable activities do you intend to carry on from the premises?
(Please see sections 1 and 14 of the Licensing Act 2003 and Schedule 1 and 2 to the Licensing Act 2003)

Provision of regulated entertainment

Please tick ✓ yes

- a) plays (if ticking yes, fill in box A)
- b) films (if ticking yes, fill in box B)
- c) indoor sporting events (if ticking yes, fill in box C)
- d) boxing or wrestling entertainment (if ticking yes, fill in box D)
- e) live music (if ticking yes, fill in box E)
- f) recorded music (if ticking yes, fill in box F)
- g) performances of dance (if ticking yes, fill in box G)
- h) anything of a similar description to that falling within (e), (f) or (g)
(if ticking yes, fill in box H)

Provision of entertainment facilities for:

- i) making music (if ticking yes, fill in box I)
- j) dancing (if ticking yes, fill in box J)
- k) entertainment of a similar description to that falling within (i) or (j)
(if ticking yes, fill in box K)

Provision of late night refreshment (if ticking yes, fill in box L)

Supply of alcohol (if ticking yes, fill in box M)

In all cases complete boxes N, O and P

A

Plays			Will the performance of a play take place indoors or outdoors or both - please tick <input checked="" type="checkbox"/> (please read guidance note 2)
Day	Start	Finish	
Standard days and timings (please read guidance note 6)			Indoors <input type="checkbox"/> Outdoors <input type="checkbox"/> Both <input type="checkbox"/>
Mon			Please give further details here (please read guidance note 3)
Tue			
Wed			State any seasonal variations for performing plays (please read guidance note 4)
Thur			
Fri			Non-standard timings. Where you intend to use the premises for the performance of plays at different times from those listed in the column on the left, please list (please read guidance note 5)
Sat			
Sun			

B

Films			Will the exhibition of films take place indoors or outdoors or both - please tick <input checked="" type="checkbox"/> (please read guidance note 2)
Day	Start	Finish	
Standard days and timings (please read guidance note 6)			Indoors <input type="checkbox"/> Outdoors <input type="checkbox"/> Both <input type="checkbox"/>
Mon			Please give further details here (please read guidance note 3)
Tue			
Wed			State any seasonal variations for the exhibition of films (please read guidance note 4)
Thur			
Fri			Non-standard timings. Where you intend to use the premises for the exhibition of films at different times from those listed in the column on the left, please list (please read guidance note 5)
Sat			
Sun			

C

Indoor sporting events			Please give further details here (please read guidance note 3)
Standard days and timings (please read guidance note 6)			
Day	Start	Finish	
Mon			
Tue			State any seasonal variations for indoor sporting events (please read guidance note 4)
Wed			
Thur			Non-standard timings. Where you intend to use the premises for indoor sporting events at different times from those listed in the column on the left, please list (please read guidance note 5)
Fri			
Sat			
Sun			

D

Boxing or wrestling entertainments			Will the boxing or wrestling entertainment take place indoors or outdoors or both - please tick <input checked="" type="checkbox"/> (please read guidance note 2)
Standard days and timings (please read guidance note 6)			
Day	Start	Finish	Indoors <input type="checkbox"/> Outdoors <input type="checkbox"/> Both <input type="checkbox"/>
Mon			Please give further details here (please read guidance note 3)
Tue			
Wed			State any seasonal variations for boxing or wrestling entertainment (please read guidance note 4)
Thur			
Fri			Non-standard timings. Where you intend to use the premises for boxing or wrestling entertainment at different times from those listed in the column on the left, please list (please read guidance note 5)
Sat			
Sun			

E

Live music			Will the performance of live music take place indoors or outdoors or both - please tick <input checked="" type="checkbox"/> (please read guidance note 2) Indoors <input type="checkbox"/> Outdoors <input type="checkbox"/> Both <input type="checkbox"/>
Standard days and timings (please read guidance note 6)			
Day	Start	Finish	Please give further details here (please read guidance note 3)
Mon			
			State any seasonal variations for the performance of live music (please read guidance note 4)
Tue			
			Non-standard timings. Where you intend to use the premises for the performance of live music at different times from those listed in the column on the left, please list (please read guidance note 5)
Wed			
Thur			
Fri			
Sat			
Sun			

F

Recorded music			Will the playing of recorded music of take place indoors or outdoors or both - please tick <input checked="" type="checkbox"/> (please read guidance note 2) Indoors <input type="checkbox"/> Outdoors <input type="checkbox"/> Both <input type="checkbox"/>
Standard days and timings (please read guidance note 6)			
Day	Start	Finish	Please give further details here (please read guidance note 3)
Mon			
			State any seasonal variations for the playing of recorded music (please read guidance note 4)
Tue			
			Non-standard timings. Where you intend to use the premises for the playing of recorded music entertainment at different times from those listed in the column on the left, please list (please read guidance note 5)
Wed			
Thur			
Fri			
Sat			
Sun			

G

Performances of dance Standard days and timings (please read guidance note 6)			Will the performance of dance take place indoors or outdoors or both - please tick <input checked="" type="checkbox"/> (please read guidance note 2)
Day	Start	Finish	Indoors <input type="checkbox"/> Outdoors <input type="checkbox"/> Both <input type="checkbox"/>
Mon			Please give further details here (please read guidance note 3)
Tue			State any seasonal variations for the performance of dance (please read guidance note 4)
Wed			Non-standard timings. Where you intend to use the premises for the performance of dance entertainment at different times from those listed in the column on the left, please list (please read guidance note 5)
Thur			
Fri			
Sat			
Sun			

H

Anything of a similar description to that falling within (e), (f) or (g) Standard days and timings (please read guidance note 6)			Please give a description of the type of entertainment you will be providing
Day	Start	Finish	Will this entertainment take place indoors or outdoors or both - please tick <input checked="" type="checkbox"/> (please read guidance note 2)
Mon			Indoors <input type="checkbox"/> Outdoors <input type="checkbox"/> Both <input type="checkbox"/>
			Please give further details here (please read guidance note 3)
Tue			
			State any seasonal variations for entertainment of a similar description to that falling within (e), (f) or (g) (please read guidance note 4)
Wed			
Thur			Non-standard timings. Where you intend to use the premises for entertainment of a similar description to that falling within (e), (f) or (g) at different times from those listed in the column on the left, please list (please read guidance note 5)
Fri			
Sat			
Sun			

Provision of facilities for making music			Please give a description of the facilities for making music you will be providing	
Standard days and timings (please read guidance note 6)			Will the facilities for making music be indoors or outdoors or both - please tick <input checked="" type="checkbox"/> (please read guidance note 2) Indoors <input type="checkbox"/> Outdoors <input type="checkbox"/> Both <input type="checkbox"/>	
Day	Start	Finish	Please give further details here (please read guidance note 3)	
Mon				
Tue				
Wed				State any seasonal variations for the provision of facilities for making music (please read guidance note 4)
Thur				
Fri				Non-standard timings. Where you intend to use the premises for provision of facilities for making music entertainment at different times from those listed in the column on the left, please list (please read guidance note 5)
Sat				
Sun				

J

Provision of facilities for dancing			Please give a description of the facilities for dancing you will be providing	
Standard days and timings (please read guidance note 6)			Will the facilities for dancing be indoors or outdoors or both - please tick <input checked="" type="checkbox"/> (please read guidance note 2) Indoors <input type="checkbox"/> Outdoors <input type="checkbox"/> Both <input type="checkbox"/>	
Day	Start	Finish	Please give further details here (please read guidance note 3)	
Mon				
Tue				
Wed				State any seasonal variations for providing dancing facilities (please read guidance note 4)
Thur				
Fri				Non-standard timings. Where you intend to use the premises for the provision of facilities for dancing entertainment at different times from those listed in the column of the left, please list (please read guidance note 5)
Sat				
Sun				

K

2

Provision of facilities for entertainment of a similar description to that falling within J or K			Please give a description of the type of entertainment facility you will be providing
Standard days and timings (please read guidance note 6)			Will the entertainment facility be indoors or outdoors or both - please tick <input checked="" type="checkbox"/> (please read guidance note 2)
Day	Start	Finish	Indoors <input type="checkbox"/> Outdoors <input type="checkbox"/> Both <input type="checkbox"/>
Mon			Please give further details here (please read guidance note 3)
Tue			State any seasonal variations for the provision of facilities for entertainment of a similar description to that falling within j or k (please read guidance note 4)
Wed			Non-standard timings. Where you intend to use the premises for the provision of facilities for entertainment of a similar description to that falling within j or k at different times from those listed in the column on the left, please list (please read guidance note 5)
Thur			
Fri			
Sat			
Sun			

Late night refreshment			Will the provision of late night refreshment take place indoors or outdoors or both - please tick <input checked="" type="checkbox"/> (please read guidance note 2)
Standard days and timings (please read guidance note 6)			
Day	Start	Finish	Indoors <input type="checkbox"/> Outdoors <input type="checkbox"/> Both <input type="checkbox"/>
Mon			Please give further details here (please read guidance note 3)
Tue			
Wed			State any seasonal variations for the provision of late night refreshment (please read guidance note 4)
Thur			
Fri			Non-standard timings. Where you intend to use the premises for the provision of late night refreshment at different times from those listed in the column on the left, please list (please read guidance note 5)
Sat			
Sun			

M			Will the sale of alcohol be for consumption - please tick box <input checked="" type="checkbox"/> (please read guidance note 7)
Standard days and timings (please read guidance note 6)			
Day	Start	Finish	On the premises <input type="checkbox"/> Off the premises <input checked="" type="checkbox"/> Both <input type="checkbox"/>
Mon	07:00		State any seasonal variations for the supply of alcohol (please read guidance note 4)
	07:00	22:00	
Tue	07:00		
	07:00	22:00	
Wed	07:00		Non-standard timings. Where you intend to use the premises for the supply of alcohol at different times from those listed in the column on the left, please list (please read guidance note 5)
	07:00	22:00	
Thur	07:00		
	07:00	22:00	
Fri	07:00		
	07:00	22:00	
Sat	07:00		
	07:00	22:00	
Sun	10:00		
	10:00	22:00	

State the name and details of the individual whom you wish to specify on the licence as premises supervisor

Name **HARDIAL MAHAL**

Address **POST OFFICE, GUNHILL, NEW ARLEY, WARKS**

Post code **CV7, 8TB**

Personal Licence number (if known) **005834**

Issuing licensing authority (if known) **SLOUGH BOROUGH COUNCIL**

N

Please highlight any adult entertainment or services, activities, other entertainment or matters ancillary to the use of the premises that may give rise to concern in respect of children (please read guidance note 8)

O

Hours premises are open to the public

Standard days and timings
(please read guidance note 6)

Day	Start	Finish
Mon		
Tue		
Wed		
Thur		
Fri		
Sat		
Sun		

State any seasonal variations (please read guidance note 4)

*Same as alcohol
See email
07/10/12
GEM*

Non-standard timings. Where you intend to use the premises to be open to the public at different times from those listed in the column on the left, please list (please read guidance note 5)

P Describe the steps you intend to take to promote the four licensing objectives:

a) General - all four licensing objectives (b, c, d, e) (please read guidance note 9)

[Empty box for general licensing objectives]

b) The prevention of crime and disorder

Internal and external CCTV cameras will be installed to CCTV code of practice. Strategically positioned and visible signage warning of these. They are to be kept in good working order, cover all points of access and egress. they are to incorporate a recording facility that allows recordings to be stored for at least a calendar month.
Police and council officers are to have access on request.
External flood lights to be positioned to illuminate the car parking areas at night.
All ground floor external windows to be glazed with toughened glass
Security shutters to all external doors apart from the front main entrance
A burglar alarm system with external alarm boxes to two elevations is to be provided and maintained by professional company.
Appropriate signs at all entrances to be provided stating No hoodie clothes

c) Public safety

The premises is to comply with all statutory fire safety controls
The premises to comply with all food safety regulations
The license holder to take steps to provide a reasonable service for disable people
Adequate space is to be provided between tables and fixed furniture for wheel chair passage
All relevant health and safety regulations are to be complied with
Adequate emergency exit signage to be displayed within the premises
All car parking areas to be kept clear of obstruction
Designated disabled parking spaces to be provided

d) The prevention of public nuisance

Noise As the previous use of the premises was a public house no increase in traffic noise is anticipated
Deliveries of stock is to be timed as not to inconvenience adjoining neighbours
Outdoor controls (offensive smells) Refuse bins are to be used and filled properly with lids securely fastened
Waste is to be collected regularly by licensed waste collector. Areas for bins to be screened and cleaned regular
Litter -waste An adequate recycling programme is to be adhered to. Bin lids to be secured. Regular observance of this
Light Pollution Control Adequate external lighting to be provided and positioned so as not to offend adjoining neighbours
Car Parking Notices advising customers to use car park and not block the highway

e) The protection of children from harm

Large visible signs to be provided warning that no alcohol, tobacco, knives etc. knives or other sharp instruments, fireworks etc to be sold to children under 18.
Any staff under 18 are not to serve any of the above
License holder to join a Challenge 25 scheme
Challenge 25 posters to be displayed in prominent positions
Regular staff meetings are to be held for updating and training purposes
Staff to be trained in checking customers ages by only accepting the following identification passport, driving licence, citizen card
The store to keep a refusal book on the premises where staff can record details of everyone who has been refused alcohol

Hollis Georgina (CEX)

From: sukhwinder mahal [gunhill2007@hotmail.com]
Sent: 07 October 2012 22:06
To: Hollis Georgina (CEX)
Subject: Re: Premises Licence Application - Blue Bell, 1 Main Street

Hi

Thanks for contacting me, I can confirm the opening hours are:

Monday - Saturday 07.00 - 22.00
Sunday 10.00 - 22.00

Many thanks

Mr Mahal

On 5 Oct 2012, at 17:51, "Hollis Georgina (CEX)" <Georgina.Hollis@sheffield.gov.uk> wrote:

Dear Mr Mahal

I am in receipt of your application for the above premises which was received by the Licensing today. I need to clarify the operating hours in the opening times section, you are able to confirm this to me by email.

Please do not hesitate to contact me should you wish to discuss this.

Kind Regards

Georgina

Georgina Hollis
Licensing Officer
Licensing General Section
Business Strategy & Regulation
Block C, Staniforth Road Depot
Staniforth Road, Sheffield, S9 3HD.

Telephone: 0114 2734264 / 2734880

Fax: 0114 2735410

Email: georgina.hollis@sheffield.gov.uk www.sheffield.gov.uk

Part or all of the information contained in this document may be subject to legal professional privilege and must not be disclosed without the prior consent of Legal & Governance Services. It may be exempt from disclosure by virtue of Section 42 of the Freedom of Information Act 2000 and Para 10, Sch 7 of the Data Protection Act 1998 P

 Please don't print this e-mail unless you really need to

This Email, and any attachments, may contain non-public information and is intended solely for the individual(s) to whom it is addressed. It may contain sensitive or protectively marked material and should be handled accordingly. If this Email has been misdirected, please notify the author immediately. If you are not the intended recipient you must not disclose, distribute, copy, print or rely on any of the information contained in it or attached, and all copies must be deleted immediately. Whilst we take reasonable steps to try to identify any software viruses, any attachments to this Email may nevertheless contain viruses which our anti-virus software has failed to identify. You should therefore carry out your own anti-virus checks before opening any documents. Sheffield City Council will not accept any liability for damage caused by computer viruses emanating from any attachment or other document supplied with this e-mail

- I have made or enclosed payment of the fee
- I have enclosed the plan of the premises
- I have sent you copies of this application and the plan to responsible authorities and others where applicable
- I have enclosed the consent form completed by the individual I wish to be premises supervisor, if applicable
- I understand that I must now advertise my application
- I understand that if I do not comply with the above requirements my application will be rejected

IT IS AN OFFENCE, LIABLE ON CONVICTION TO A FINE UP TO LEVEL 5 ON THE STANDARD SCALE [^{*insert amount}], UNDER SECTION 158 OF THE LICENSING ACT 2003 TO MAKE A FALSE STATEMENT IN OR IN CONNECTION WITH THIS APPLICATION

Part 5 - Signatures (please read guidance note 10)

Signature of applicant or applicant's solicitor or other duly authorised agent. (Please read guidance note 11)
If signing on behalf of the applicant please state in what capacity.

Signature 

Date 27/9/12

Capacity

For joint applications signature of 2nd applicant, 2nd applicant's solicitor or other authorised agent.
(Please read guidance note 12)

If signing on behalf of the applicant please state in what capacity.

Signature _____

Date

Capacity

Contact name (where not previously given) and postal address for correspondence associated with this application (please read guidance note 13)	
Post town	Post code
Telephone number (if any)	
If you would prefer us to correspond with you by e-mail your e-mail address (optional)	

Notes for Guidance

1. Describe the premises. For example the type of premises, its general situation and layout and any other information which could be relevant to the licensing objectives. Where your application includes off-supplies of alcohol and you intend to provide a place for consumption of these off-supplies you must include a description of where the place will be and its proximity to the premises.
2. Where taking place in a building or other structure please tick as appropriate. Indoors may include a tent.
3. For example the type of activity to be authorised, if not already stated, and give relevant further details, for example (but not exclusively) whether or not music will be amplified or unamplified.
4. For example (but not exclusively), where the activity will occur on additional days during the summer months.
5. For example (but not exclusively), where you wish the activity to go on longer on a particular day i.e Christmas Eve.
6. Please give timings in 24 hour clock (e.g. 16:00) and only give details for the days of the week when you intend the premises to be used for the activity.
7. If you wish people to be able to consume alcohol on the premises please tick 'on the premises', if you wish people to be able to purchase alcohol to consume away from the premises please tick 'off the premises'. If you wish people to be able to do both please tick 'both'.
8. Please give information about anything intended to occur at the premises or ancillary to the use of the premises which may give rise to concern in respect of children, regardless of whether you intend children to have access to the premises, for example (but not exclusively) nudity or semi-nudity, films for restricted age groups, the presence of gaming machines.
9. Please list here steps you will take to promote all four licensing objectives together.
10. The application form must be signed.
11. An applicant's agent (for example solicitor) may sign the form on their behalf provided that they have actual authority to do so.
12. Where there is more than one applicant, both applicants or their respective agents must sign the application form.
13. This is the address which we shall use to correspond with you about this application.

Consent of individual to being specified as premises supervisor

I [full name of prospective premises supervisor]
HARDIAL MAHAL

of [home address of prospective premises supervisor]
POST OFFICE
GUNHILL
NEW ARLEY
WARKS
CV7 8HB

hereby confirm that I give my consent to be specified as the designated premises supervisor in relation to the application for

[type of application] PREMISES LICENSE

by

[name of applicant] HARDIAL MAHAL

relating to a premises licence

[number of existing licence, if any]

for

[name and address of premises to which the application relates]
BLUE BELL INN
1 MAIN STREET
SHEFFIELD
S12 4LA

and any premises licence to be granted or varied in respect of this application made by

[name of applicant]

concerning the supply of alcohol at

[name and address of premises to which application relates]

I also confirm that I am applying for, intend to apply for or currently hold a personal licence, details of which I set out below.

Personal licence number 005834

[insert personal licence number, if any]

Personal licence issuing authority

SLOUGH BOROUGH COUNCIL

[insert name and address and telephone number of personal licence issuing authority, if any]

Signed



Name (please print)

HARDIAL SINGH MAHAL

Date

27/9/12

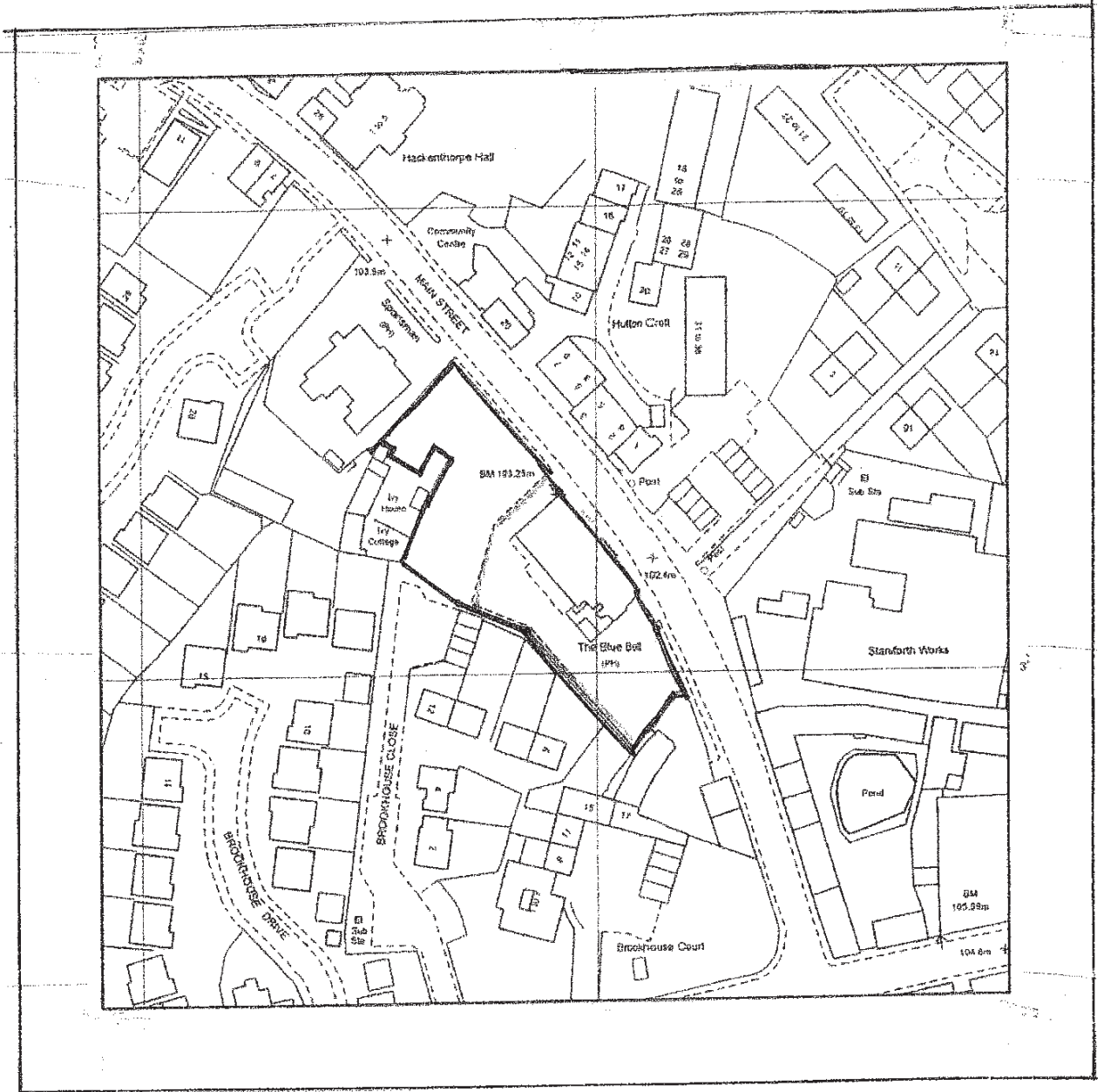

LOCATION PLAN 1:1250



Hollis Georgina (CEX)**From:** sukhwinder mahal [gunhill2007@hotmail.com]**Sent:** 24 October 2012 11:12**To:** Hollis Georgina (CEX)**Subject:** Re: Application for a premises licence - Blue Bell, Main Street, Hackenthorpe, Sheffield*Sent plan via email showing
licensed area - red line added!*

Dear Georgina,

I would like to confirm the points that you have raised in this email, in regards to the premises licence applied for 1 Main St. I am happy to press forward with these amendments and continue with the application.

I hope this confirmation is enough to proceed.

Many thanks

Mr Mahal

On 24 Oct 2012, at 10:15, "Hollis Georgina (CEX)" <Georgina.Hollis@sheffield.gov.uk> wrote:

Dear Mr Mahal,

Following our telephone conversation regarding your application, please could you confirm the following points in relation to the plan that you have submitted:-

- You are applying for off sales from the convenience store only.
- The Café to the left hand side is separate and no alcohol sales will be made from here - I can then indicate this by putting a line around the area to be licensed for off sales of alcohol, however I need you to agree to this amendment. I will scan a copy of the plan with the line showing this and you will need to agree to this amended plan asap.

Regards

Georgina

Georgina Hollis
Licensing Officer
Licensing General Section
Business Strategy & Regulation
Block C, Staniforth Road Depot
Staniforth Road, Sheffield, S9 3HD.

Telephone: 0114 2734264 / 2734880

Fax: 0114 2735410

Email: General.Licensing@sheffield.gov.uk www.sheffield.gov.uk

Part or all of the information contained in this document may be subject to legal professional privilege and must not be disclosed without the prior consent of Legal & Governance Services. It may be exempt from disclosure by virtue of Section 42 of the Freedom of Information Act 2000 and Para 10, Sch 7 of the Data Protection Act 1998 P

 Please don't print this e-mail unless you really need to

This Email, and any attachments, may contain non-public information and is intended solely for the individual(s) to whom it is addressed. It may contain sensitive or protectively marked material and should be handled accordingly. If this Email has been misdirected, please notify the author immediately. If you are not the intended recipient you must not disclose, distribute, copy, print or rely on any of the information contained in it or attached, and all copies must be deleted immediately. Whilst we take reasonable steps to try to identify any software viruses, any attachments to this Email may nevertheless contain viruses which our anti-virus software has failed to identify. You should therefore carry out your own anti-virus checks before opening any documents. Sheffield City Council will not accept any liability for damage caused by computer viruses emanating from any attachment or other document supplied with this e-mail

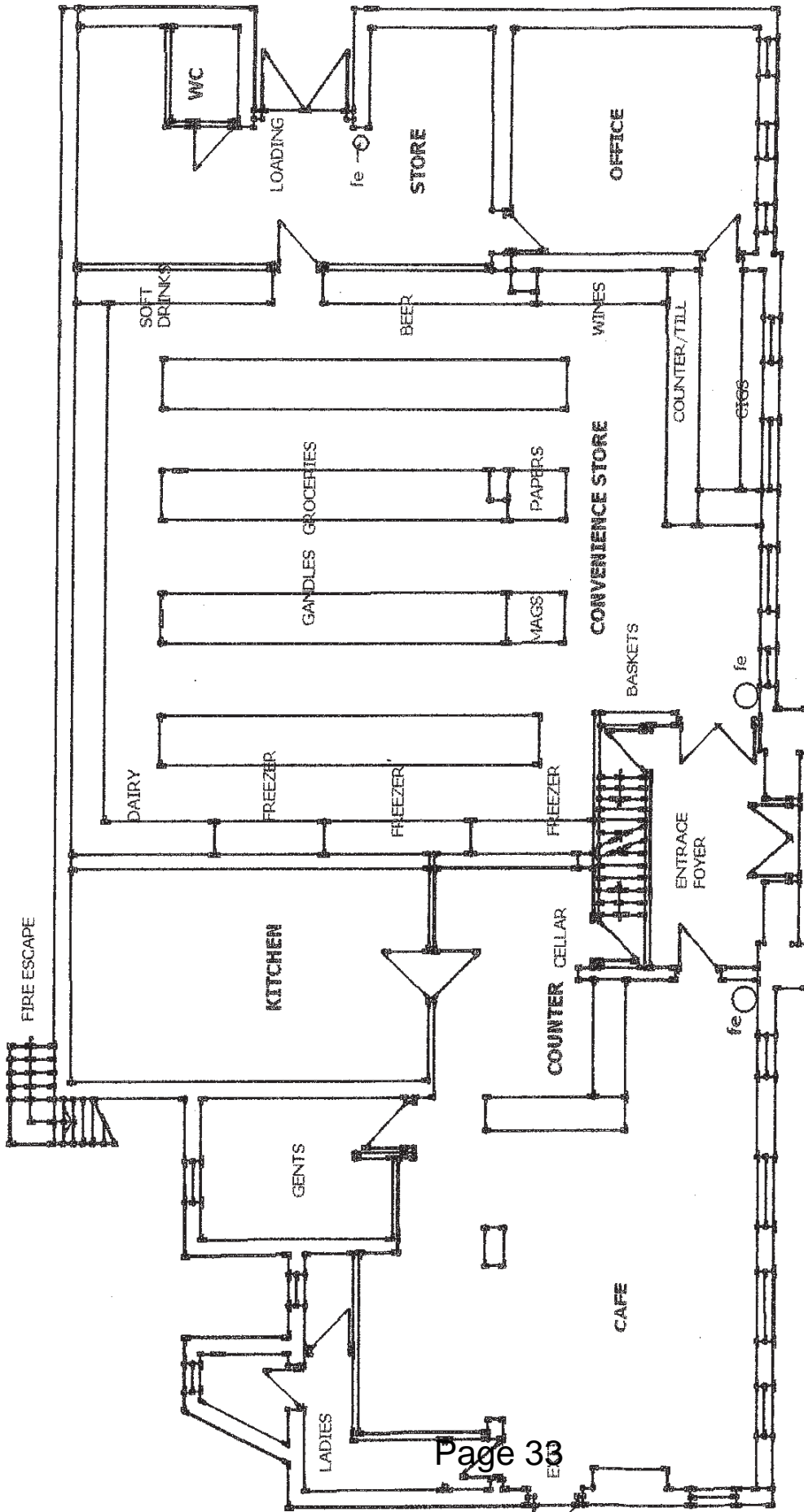

GROUND FLOOR PLAN 1:200

PROPOSED CONVENIENCE STORE AND CAFE, 1 MAIN STREET S12 4LA P1

Hollis Georgina (CEX)

From: sukhwinder mahal [gunhill2007@hotmail.com]
Sent: 24 October 2012 12:11
To: Hollis Georgina (CEX)
Subject: Re: PLAN - AMENDMENT

Dear Georgina,

I am happy with the plan and also can confirm the cafe will not be operating after 23.00.

Many thanks

Mr Mahal

On 24 Oct 2012, at 11:44, "Hollis Georgina (CEX)" <Georgina.Hollis@sheffield.gov.uk> wrote:

> Dear Mr Mahal
>
> Please see attached plan - please confirm that you are accepting this plan as an amendment to show the licensed area for alcohol sales and that the café is to be kept separate and not licensed for alcohol sales or any other licensable activity.
>
> For clarification - please also confirm that the café is not operating after 23:00 hours as some residents are confused to what you are applying for.

> Regards
>
> Georgina

> _____
> Georgina Hollis
> Licensing Officer
> Licensing General Section
> Business Strategy & Regulation
> Block C, Staniforth Road Depot
> Staniforth Road, Sheffield, S9 3HD.
>
> Telephone: 0114 2734264 / 2734880
> Fax: 0114 2735410
> Email: General.Licensing@sheffield.gov.uk www.sheffield.gov.uk

> _____
> Part or all of the information contained in this document may be
> subject to legal professional privilege and must not be disclosed
> without the prior consent of Legal & Governance Services. It may be
> exempt from disclosure by virtue of Section 42 of the Freedom of
> Information Act 2000 and Para 10, Sch 7 of the Data Protection Act
> 1998 P

> P Please don't print this e-mail unless you really need to

>
>
> This Email, and any attachments, may contain non-public information
> and is intended solely for the individual(s) to whom it is addressed.
> It may contain sensitive or protectively marked material and should be
> handled accordingly. If this Email has been misdirected, please
> notify the author immediately. If you are not the intended recipient
> you must not disclose, distribute, copy, print or rely on any of the
> information contained in it or attached, and all copies must be
> deleted immediately. Whilst we take reasonable steps to try to
> identify any software viruses, any attachments to this Email may
> nevertheless contain viruses which our anti-virus software has failed
> to identify. You should therefore carry out your own anti-virus

> checks before opening any documents. Sheffield City Council will not
> accept any liability for damage caused by computer viruses emanating
> from any attachment or other document supplied with this e-mail
>
> <DOC241012-24102012113850.pdf>

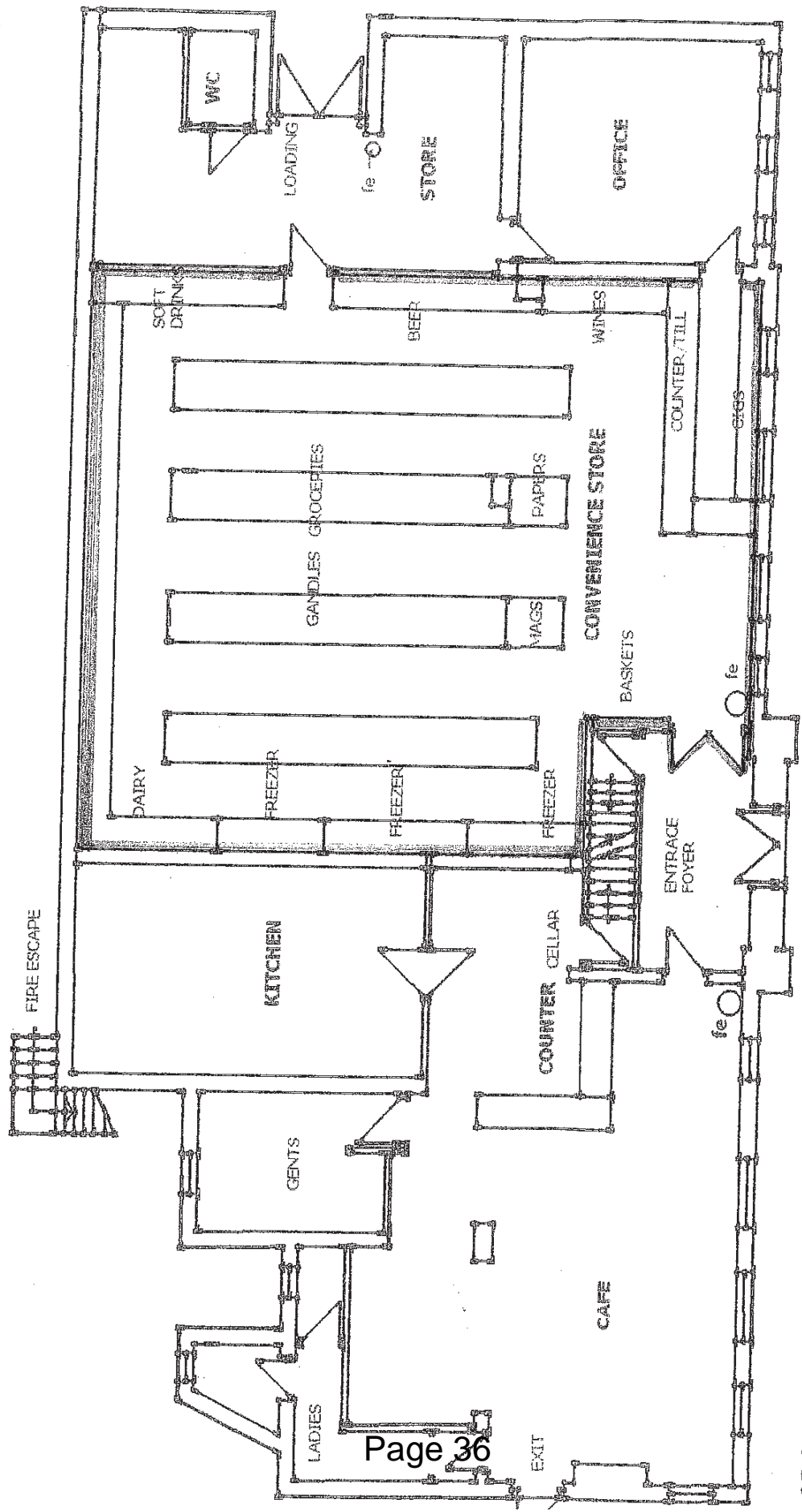

GROUND FLOOR PLAN 1:200

PROPOSED CONVENIENCE STORE AND CAFE, 1 MAIN STREET S12 4LA P1

Appendix 'B

Sheffield City Council
Licensing Section Block C
Staniforth Road Depot
Staniforth Road
Sheffield
S9 3HD

Dear Sir

As a resident living in close proximity to the Blue Bell Main Street
Hackenthorpe,

I wish to object to the granting of a premises license for the sale of alcohol and
late night refreshment at the above premises.

I live close by and will be affected by the increase in noise during the day and
late at night, my concern about the youths gathering on Main Street near to
elderly persons sheltered accommodation and the increase in traffic and
parking problems it will bring to an already congested road.
Finally the recent problems with the underage drinking and the history of
drugs and violence that took place at the Blue Bell, requiring the intervention
of the local Police. A premises licence should not be granted under any
circumstances.

Yours sincerely *[Handwritten Signature]*

Name *[Handwritten Name]*

Address *[Redacted]* *[Handwritten Address]*

Hollis Georgina (CEX)

From: Kath and Ian Bower [REDACTED]
Sent: 24 October 2012 16:19
To: Licensing(General)
Subject: Blue Bell, Main Street, Hackenthorpe
Attachments: Licensing Objection 241012.docx

Following our conversation with your office today, please find attached our objection to the application for the Blue Bell, Main Street, Hackenthorpe.

=====
Email scanned by PC Tools - No viruses or spyware found.
(Email Guard: 9.0.0.2308, Virus/Spyware Database: 6.20820)
<http://www.pctools.com>
=====

HH
Brookhouse Court
Hackenthorpe
SHEFFIELD
S12 4NN

Tel: [REDACTED]

Email: [REDACTED]

24 October 2012

Ms J Gough
Licensing – General Section
Sheffield City Council
Licensing Section Block C
Staniforth Road Depot
Staniforth Road
SHEFFIELD
S1 2HH

Dear Ms Gough

Application for Alcohol Licence - Blue Bell Public House, Hackenthorpe

We are writing to lodge our objection to the latest application for these premises.

We understand this one is for an off licence and convenience store to be located in the right hand part of the building, looking at it from the street and run that the licence is to be from 7.00 am to 10.00 pm, 7 days per week.

As we have said before, many times, we have lived here for 21 years and at various times have endured all types of nuisance from these premises, which back onto our garden. Without exception, this nuisance has been as a result of excess alcohol consumption and the inability of successive owners to contain their customers and noise within the building.

Whilst we accept this is a new owner, applying for a new type of licence, we still feel that the sale of alcohol will encourage the return of the undesirable clientele who frequented the public house in the past. They will, we feel, purchase alcohol and congregate in numbers around the building and in the car park, causing noise, public disorder and vandalism nuisances to everyone who lives nearby.

There is a very good off licence and convenience store close by, which whilst providing an excellent service to the community, attracts numbers of people around it at night-time, making it an unpleasant experience to shop there in the evening. This store, however, is at least separated from housing at close quarters and is part of an already established shopping parade. The Blue Bell is in the middle of residential properties, some of which are in very close proximity indeed to it. Therefore the problem will affect far more people in their own homes.

In addition, we understand the owners intend to open a cafe at the left hand side of the building where late night refreshments will be offered. Whilst you tell us this is no concern of yours at present, we fear that alcohol will be purchased in the off licence and consumed in the cafe or outside it on the car park adjacent, thus presenting us with exactly the same problems we have suffered in the past as our garden backs directly onto the car park. In the past conditions have been placed on the owners stating that there should be no furniture outside the building which would enable this to happen. We think this is crucial to any decision taken, if not by you at this time, then in the future, should the owners wish to vary their licence to include the cafe.

We hope the above demonstrates to you the need to turn down this application for the sake of the residents of this area. Our children bring their children here and long may they continue to do so, in the peace and safety we have enjoyed since the premises were closed last year.

Yours sincerely
D I BOWER (MR) AND K M BOWER (MRS)

Blue Bell Planning Objection 241012

Sheffield City Council
Licensing Section Block C
Staniforth Road Depot
Staniforth Road
Sheffield
S9 3HD

Dear Sir

As a resident living in close proximity to the Blue Bell Main Street
Hackenthorpe,

I wish to object to the granting of a premises license for the sale of alcohol and
late night refreshment at the above premises.

I live close by and will be affected by the increase in noise during the day and
late at night, my concern about the youths gathering on Main Street near to
elderly persons sheltered accommodation and the increase in traffic and
parking problems it will bring to an already congested road.
Finally the recent problems with the underage drinking and the history of
drugs and violence that took place at the Blue Bell, requiring the intervention
of the local Police. A premises licence should not be granted under any
circumstances.

Yours sincerely

Name

J. Blythe

Address

Huttoncroft
Hackenthorpe
Sheffield

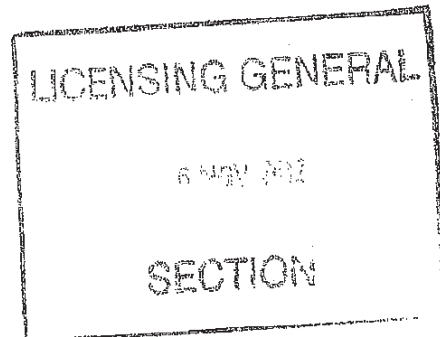

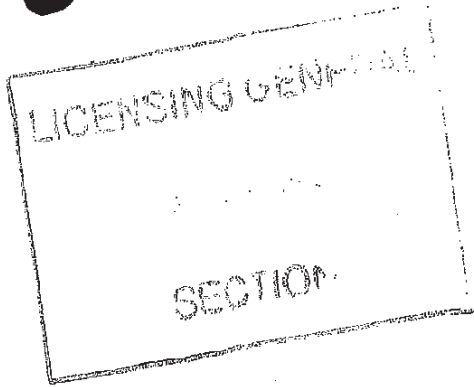

Sheffield City Council
Licensing Section Block C
Staniforth Road Depot
Staniforth Road
Sheffield
S9 3HD

Dear Sir

As a resident living in close proximity to the Blue Bell Main Street
Hackenthorpe,

I wish to object to the granting of a premises license for the sale of alcohol and
late night refreshment at the above premises.

I live close by and will be affected by the increase in noise during the day and
late at night, my concern about the youths gathering on Main Street near to
elderly persons sheltered accommodation and the increase in traffic and
parking problems it will bring to an already congested road.

Finally the recent problems with the underage drinking and the history of
drugs and violence that took place at the Blue Bell, requiring the intervention
of the local Police. A premises licence should not be granted under any
circumstances.

Yours sincerely

Name MRS. A. BLUFF

Address Hutton Croft.
Sheffield S12 4L7

Sheffield City Council
Licensing Section Block C
Staniforth Road Depot
Staniforth Road
Sheffield
S9 3HD

Dear Sir

As a resident living in close proximity to the Blue Bell Main Street
Hackenthorpe,

I wish to object to the granting of a premises license for the sale of alcohol and
late night refreshment at the above premises.

I live close by and will be affected by the increase in noise during the day and
late at night, my concern about the youths gathering on Main Street near to
elderly persons sheltered accommodation and the increase in traffic and
parking problems it will bring to an already congested road.
Finally the recent problems with the underage drinking and the history of
drugs and violence that took place at the Blue Bell requiring the intervention
of the local Police. A premises licence should not be granted under any
circumstances.

LICENSING GENERAL
- 1 NOV 2012
SECTION

Yours sincerely

Name *Ms Halden*

Address *Hutton Croft
Hackenthorpe
Sheffield*

Sheffield City Council
Licensing Section Block C
Staniforth Road Depot
Staniforth Road
Sheffield
S9 3HD

Dear Sir

As a resident living in close proximity to the Blue Bell Main Street
Hackenthorpe,

I wish to object to the granting of a premises license for the sale of alcohol and
late night refreshment at the above premises.

I live close by and will be affected by the increase in noise during the day and
late at night, my concern about the youths gathering on Main Street near to
elderly persons sheltered accommodation and the increase in traffic and
parking problems it will bring to an already congested road.
Finally the recent problems with the underage drinking and the history of
drugs and violence that took place at the Blue Bell, requiring the intervention
of the local Police. A premises licence should not be granted under any
circumstances.

Yours sincerely

Name

Mrs. A. Booth

Address

*[Redacted] Hackenthorpe
Sheffield S10 4JY*

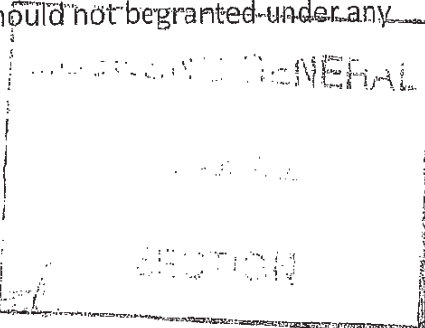

Sheffield City Council
Licensing Section Block C
Staniforth Road Depot
Staniforth Road
Sheffield
S9 3HD

Dear Sir

As a resident living in close proximity to the Blue Bell Main Street
Hackenthorpe,

I wish to object to the granting of a premises license for the sale of alcohol and
late night refreshment at the above premises.

I live close by and will be affected by the increase in noise during the day and
late at night, my concern about the youths gathering on Main Street near to
elderly persons sheltered accommodation and the increase in traffic and
parking problems it will bring to an already congested road.
Finally the recent problems with the underage drinking and the history of
drugs and violence that took place at the Blue Bell, requiring the intervention
of the local Police. A premises licence should not be granted under any
circumstances.

Yours sincerely

Name *S. Howe*

Address  MAIN STREET HACKENTHORPE
SHEFFIELD S12 4LB

GENERAL
LICENSING
SECTION
- 9 NOV 2012

Sheffield City Council
Licensing Section Block C
Staniforth Road Depot
Staniforth Road
Sheffield
S9 3HD

Dear Sir

As a resident living in close proximity to the Blue Bell Main Street
Hackenthorpe,

I wish to object to the granting of a premises license for the sale of alcohol and
late night refreshment at the above premises.

I live close by and will be affected by the increase in noise during the day and
late at night, my concern about the youths gathering on Main Street near to
elderly persons sheltered accommodation and the increase in traffic and
parking problems it will bring to an already congested road.

Finally the recent problems with the underage drinking and the history of
drugs and violence that took place at the Blue Bell, requiring the intervention
of the local Police. A premises licence should not be granted under any
circumstances.

Yours sincerely

Name Mrs J Howe

Address ~~515~~ Main St
Hackenthorpe Sheffield

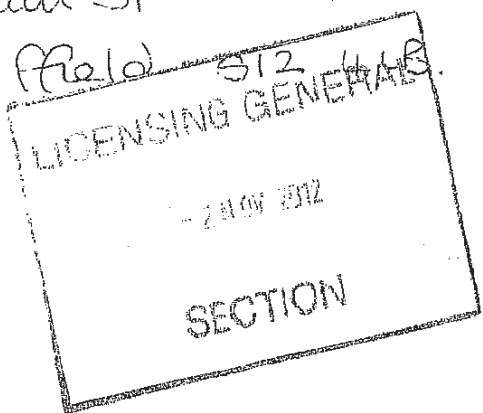

Sheffield City Council
Licensing Section Block C
Staniforth Road Depot
Staniforth Road
Sheffield
S9 3HD

Dear Sir

As a resident living in close proximity to the Blue Bell Main Street
Hackenthorpe,

I wish to object to the granting of a premises license for the sale of alcohol and
late night refreshment at the above premises.

I live close by and will be affected by the increase in noise during the day and
late at night, my concern about the youths gathering on Main Street near to
elderly persons sheltered accommodation and the increase in traffic and
parking problems it will bring to an already congested road.

Finally the recent problems with the underage drinking and the history of
drugs and violence that took place at the Blue Bell, requiring the intervention
of the local Police. A premises licence should not be granted under any
circumstances.

Yours sincerely



Name

MR M. GEGAN

Address

HUTTON COURT
SHEFFIELD S12 4PH

Mr & Mrs P Dickinson
Hutton Croft
Sheffield S 12 4ly

25-10-2012

To the Sheffield City Council licensing.

Objection to the alcohol and late refreshments.

To the licencing board ,

We feel that if the licence is granted we will have underage drinking ,drug abuse, rowdy youths throwing bottles and beer cans all over the road and on the entrance of hutton croft,also excessive noise.

We do not object to the shop but the café should be closed by 16-00pm. as the owner said . mon – sat. and the drinks licence should be limited till 20-00 pm .

We are just getting back to a normal life .. trouble free .since the bell closed we all don't want this to start again

We are also concerned about these late night refreshments as this is not what the owner as been and told everybody in the vicinity.

Thanking you.

YOURS FAITHFULLY



6/11

Sheffield City Council
Licensing Section Block C
Staniforth Road Depot
Staniforth Road
Sheffield
S9 3HD

Dear Sir

As a resident living in close proximity to the Blue Bell Main Street
Hackenthorpe,

I wish to object to the granting of a premises license for the sale of alcohol and
late night refreshment at the above premises.

I live close by and will be affected by the increase in noise during the day and
late at night, my concern about the youths gathering on Main Street near to
elderly persons sheltered accommodation and the increase in traffic and
parking problems it will bring to an already congested road.
Finally the recent problems with the underage drinking and the history of
drugs and violence that took place at the Blue Bell, requiring the intervention
of the local Police. A premises licence should not be granted under any
circumstances.

Yours sincerely

Name *A. Sedgwick*

Address  *Hutton Croft
Hackenthorpe
S12 4LY*

*would be better
having a shop
instead of a pub.*



Sheffield City Council
Licensing Section Block C
Staniforth Road Depot
Staniforth Road
Sheffield
S9 3HD

Dear Sir

As a resident living in close proximity to the Blue Bell Main Street
Hackenthorpe,

I wish to object to the granting of a premises license for the sale of alcohol and
late night refreshment at the above premises.

I live close by and will be affected by the increase in noise during the day and
late at night, my concern about the youths gathering on Main Street near to
elderly persons sheltered accommodation and the increase in traffic and
parking problems it will bring to an already congested road.
Finally the recent problems with the underage drinking and the history of
drugs and violence that took place at the Blue Bell, requiring the intervention
of the local Police. A premises licence should not be granted under any
circumstances.

Yours sincerely

Gary Bailey
Name GARY BAILEY

Address ■ BEIGHTON ROAD
HACKENTHORPE
SHEFFIELD
S12 4LP

Sheffield City Council
Licensing Section Block C
Staniforth Road Depot
Staniforth Road
Sheffield
S9 3HD

Dear Sir

As a resident living in close proximity to the Blue Bell Main Street
Hackenthorpe,

I wish to object to the granting of a premises license for the sale of alcohol and
late night refreshment at the above premises.

I live close by and will be affected by the increase in noise during the day and
late at night, my concern about the youths gathering on Main Street near to
elderly persons sheltered accommodation and the increase in traffic and
parking problems it will bring to an already congested road.
Finally the recent problems with the underage drinking and the history of
drugs and violence that took place at the Blue Bell, requiring the intervention
of the local Police. A premises licence should not be granted under any
circumstances.

Yours sincerely

Name	MRS M. E. PLEDGER	M. E. Pledger
	MR. R. S. PLEDGER	
Address	HUTTON CROFT	R. S. Pledger
	512 44Y	

Sheffield City Council
Licensing Section Block C
Staniforth Road Depot
Staniforth Road
Sheffield
S9 3HD

Dear Sir

As a resident living in close proximity to the Blue Bell Main Street
Hackenthorpe,

I wish to object to the granting of a premises license for the sale of alcohol and
late night refreshment at the above premises.

I live close by and will be affected by the increase in noise during the day and
late at night, my concern about the youths gathering on Main Street near to
elderly persons sheltered accommodation and the increase in traffic and
parking problems it will bring to an already congested road.
Finally the recent problems with the underage drinking and the history of
drugs and violence that took place at the Blue Bell, requiring the intervention
of the local Police. A premises licence should not be granted under any
circumstances.

Yours sincerely

LICENSING GENERAL
30 OCT 2012
SECTION

Name

JEAN ANDFIELD

Address

HUTTON CROFT
MAIN ST
SHEFFIELD
S12 4LY

Sheffield City Council
Licensing Section Block C
Staniforth Road Depot
Staniforth Road
Sheffield
S9 3HD

Dear Sir

As a resident living in close proximity to the Blue Bell Main Street
Hackenthorpe,

I wish to object to the granting of a premises license for the sale of alcohol and
late night refreshment at the above premises.

I live close by and will be affected by the increase in noise during the day and
late at night, my concern about the youths gathering on Main Street near to
elderly persons sheltered accommodation and the increase in traffic and
parking problems it will bring to an already congested road.

Finally the recent problems with the underage drinking and the history of
drugs and violence that took place at the Blue Bell, requiring the intervention
of the local Police. A premises licence should not be granted under any
circumstances.

Yours sincerely

Name MR & MRS J D WILSON

Address HUTTON CROFT

HACKENTHORPE

SHEFFIELD

S12 4RY

Sheffield City Council
Licensing Section Block C
Staniforth Road Depot
Staniforth Road
Sheffield
S9 3HD

Dear Sir

As a resident living in close proximity to the Blue Bell Main Street
Hackenthorpe,

I wish to object to the granting of a premises license for the sale of alcohol and
late night refreshment at the above premises.

I live close by and will be affected by the increase in noise during the day and
late at night, my concern about the youths gathering on Main Street near to
elderly persons sheltered accommodation and the increase in traffic and
parking problems it will bring to an already congested road.
Finally the recent problems with the underage drinking and the history of
drugs and violence that took place at the Blue Bell, requiring the intervention
of the local Police. A premises licence should not be granted under any
circumstances.

Yours sincerely

Name *by M Lawler*

Address *HUTTON GROVE
HACKENTHORPE
S12 4LY*

GAH
Sheffield City Council
Licensing Section Block C
Staniforth Road Depot
Staniforth Road
Sheffield
S9 3HD

Dear Sir

As a resident living in close proximity to the Blue Bell Main Street
Hackenthorpe,

I wish to object to the granting of a premises license for the sale of alcohol and
late night refreshment at the above premises.

I live close by and will be affected by the increase in noise during the day and
late at night, my concern about the youths gathering on Main Street near to
elderly persons sheltered accommodation and the increase in traffic and
parking problems it will bring to an already congested road.
Finally the recent problems with the underage drinking and the history of
drugs and violence that took place at the Blue Bell, requiring the intervention
of the local Police. A premises licence should not be granted under any
circumstances.

Yours sincerely

Name *D. Islam*

Address  *Hutton Croft*
Sheffield S12. 4LY.

Mr & Mrs M Rowbotham
Hutton Croft
Sheffield S12 4ly

23/10/2012

For the attention of Sheffield city licencing :

Objection to Licence and late night refreshments application .

Dear committee,

- 1. The reasons are as follows , the hours of opening 7-0am. 22-00pm. Seven days a week selling alcohol and the late night refreshment.

I have asked the owner what he proposed to do and he said a café at the left side and a convenient come off licence at the right side and he said the café would run 7-0 am to 14-00pm. approx. , But why late night refreshments .

We live on Hutton Croft and we feel that the hours of selling alcohol till 22-00pm. is a little late I have concerns as there are directly across the road, council garages at the side of hutton croft and you will get youths and underage drinking, smoking, drugs, urinating etc, on this site and on hutton croft causing problems like we had when the bluebell was open always having to have police present with fighting etc. we are all pensioners and don't need these problems anymore.

There are double yellow lines on the road out side the blue bell and this road (main street is very busy indeed ,and added loading and unloading would be a added issue

- 2. I know the chap as to make a living but if the café is to close at approx. 14-00pm as he said that is fine. Also the convenient store is fine. But we feel that late night refreshment, we don't agree with this as this would cause problems again noise, smoking, swearing, etc, everything what went off outside the front and back of the bell and this would cause problems .

The shop is ok but the hours of selling alcohol should be certainly closely looked at with all the problems that we have had in the past .

There should be a ban on drinking alcohol in public within a set distance of the shop like in the woodhouse centre

Yours faithfully.

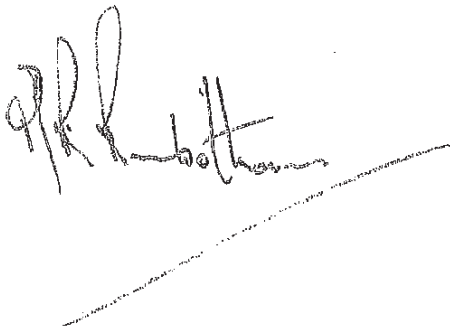

Sheffield City Council
Licensing Section Block C
Staniforth Road Depot
Staniforth Road
Sheffield
S9 3HD

Dear Sir

As a resident living in close proximity to the Blue Bell Main Street
Hackenthorpe,

I wish to object to the granting of a premises license for the sale of alcohol and
late night refreshment at the above premises.

I live close by and will be affected by the increase in noise during the day and
late at night, my concern about the youths gathering on Main Street near to
elderly persons sheltered accommodation and the increase in traffic and
parking problems it will bring to an already congested road.
Finally the recent problems with the underage drinking and the history of
drugs and violence that took place at the Blue Bell, requiring the intervention
of the local Police. A premises licence should not be granted under any
circumstances.

Yours sincerely

Name *J. J. Barnes & H. Barnes*

Address
*■ Hutton Croft
Main St
Hackenthorpe
S12 4LY*



Sheffield City Council
Licensing Section Block C
Staniforth Road Depot
Staniforth Road
Sheffield
S9 3HD

Dear Sir

As a resident living in close proximity to the Blue Bell Main Street
Hackenthorpe,

I wish to object to the granting of a premises license for the sale of alcohol and
late night refreshment at the above premises.

I live close by and will be affected by the increase in noise during the day and
late at night, my concern about the youths gathering on Main Street near to
elderly persons sheltered accommodation and the increase in traffic and
parking problems it will bring to an already congested road.
Finally the recent problems with the underage drinking and the history of
drugs and violence that took place at the Blue Bell, requiring the intervention
of the local Police. A premises licence should not be granted under any
circumstances.

Yours sincerely

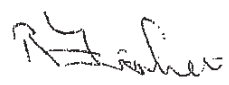

Name

ROY FISHER

Address

HUTTON CROFTS
HACKENTHORPE
SHEFFIELD
S12 4LY

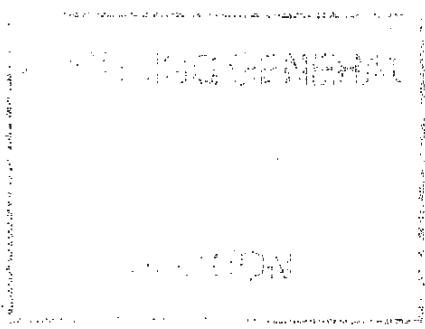

Sheffield City Council
Licensing Section Block C
Staniforth Road Depot
Staniforth Road
Sheffield
S9 3HD

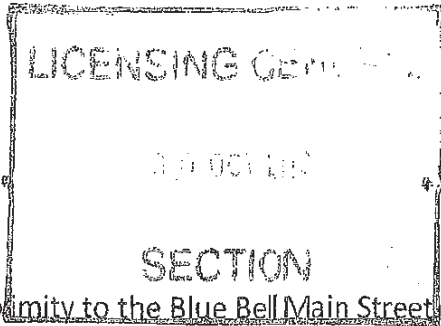

Dear Sir

As a resident living in close proximity to the Blue Bell Main Street
Hackenthorpe,

I wish to object to the granting of a premises license for the sale of alcohol and
late night refreshment at the above premises.

I live close by and will be affected by the increase in noise during the day and
late at night, my concern about the youths gathering on Main Street near to
elderly persons sheltered accommodation and the increase in traffic and
parking problems it will bring to an already congested road.
Finally the recent problems with the underage drinking and the history of
drugs and violence that took place at the Blue Bell, requiring the intervention
of the local Police. A premises licence should not be granted under any
circumstances.

Yours sincerely

Name *Mrs Dorothy Meyer.*

Address *Hutton Croft
Main Street.*

D. Meyer.

Dear Hackenthorpe Resident

You may or may not be aware that the new owners of the Blue Bell are applying for a licence for the sale of alcohol and the provision of late night refreshment.

This could cause extra traffic on an already busy road, with the associated parking problems caused by loading and unloading. But mainly the concerns are about the noise, safety and underage drinking and the congregation of youths on Main Street.

If you wish you can object to:

Sheffield City Council
Licensing Section Block C
Staniforth Road Depot
Staniforth Road
Sheffield
S9 3HD

I have enclosed a Short letter that you may use with the Pre-paid envelope enclosed.

But please make sure you sign it and put your address on the bottom of the letter.

Meeting department

I am writing this letter to Strongly Object to the application allowing for late night refreshments at the Blue Bell pub on Main Street, Sheffield. My reason for this is because I very strongly believe that if this goes ahead all the problems we have had for the past years the pub will receive during this time my partner and I witnessed on many occasions Customers urinating against our wall (whilst children were at the pub) urinating against other Customers Cars, Customers smoking drugs outside the pub (we could smell it in our garden and see them from our window).

The constant noise even from inside our house from customers sitting outside being abusive and using offensive language. We have even had glass thrown over our wall into our garden. My partner and I work very hard but have on many occasions had to stay at relatives homes just to get some sleep due to the noise the pub's customers make. To allow this to happen would be a huge kick in the face to the many residents like myself and others (many of whom are pensioners) who spent many nights for years phoning 101, the police, Woodhouse Super neighbourhood and writing letters even giving statements against this pub just so we could have a normal quality of life. I also feel that it would be a huge kick in the

fine to the officers who were called out
 on many occasions because of this pub's
 customers. I would also like to remind
 you that this pub licence was
 removed only a year ago after a very
 violent attack occurred there and police
 had to yet again attend. I would also
 like to note that over the years
 the pub has had many landlords
 most of whom have been very experienced
 and we have been promised countless
 times that things will change and all the
 ever happened is that it's always got
 one experienced landlord who obviously
 thought he could "turn the pub around"
 gave evidence against the pub having
 a licence. I also hope all past visits
 and letters from residents and police are
 read very carefully before a final
 decision is made because after living
 here for 7 years and witnessing many
 countless landlords I know that the
 building attracts trouble makers who love
 to make noise be abusive and bawdle
 in the lives of residents, I am aware
 whoever has bought the pub has to
 make a living but there are plenty of
 other possibilities for a building this size
 than yet again making residents live
 hell and wasting police time yet again
 after just getting our lives back.
 I member this pub didn't lose its licence
 nothing. Thank you *df* Abigail Gray

Sheffield City Council
 Licensing Section Block C
 Staniforth Road Depot
 Staniforth Road
 Sheffield
 S9 3HD

LICENSING DEPARTMENT

HEALTHY

Dear Sir or Madam

As a resident living in close proximity to the Blue Bell, Main Street, Hackenthorpe and a business owner working across the road from these premises, I wish to object to the granting of a premises license for the sale of alcohol and late night refreshment at the above premises.

I work across the road from the Blue Bell and I am acutely aware of the existing traffic congestion and parking problems. Any increase would be intolerable.

Fireworks are usually sold from the premises next to the Blue Bell and there are enough noise and behaviour problems at this time of year without the addition of alcohol.

I am aware there are a number of elderly people living close by and that their lives were blighted by noise and violent activity when the Blue Bell was open as a public house. We don't want these problems re-introduced.

A premises licence should not be granted in any circumstances.

Yours faithfully



A Rippon
 JAKS graphics
 Unit S3 Staniforth Works
 Main Street
 Hackenthorpe
 Sheffield
 S12 4LB



Sheffield City Council
 Licensing Section Block C
 Staniforth Road Depot
 Staniforth Road
 Sheffield
 S9 3HD

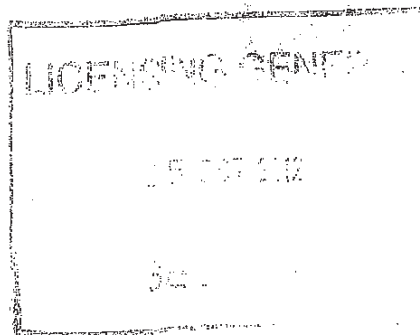

22nd October 2012

Ref application: Premises Licence Blue Bell, 1 Main Street, Hackenthorpe.

As a local Business Owner having a business in the vicinity of the proposed application for a premises licence. I am extremely concerned to find an application has been submitted for a Premises licence to allow the sale of alcohol at the above site 7 days a week from 7.00am to 10.00pm Monday to Saturday and 10.00am to 10.00pm Sunday.

As a previous Premises licence was surrendered because of the trouble being brought to the neighbourhood. We feel that the area has calmed down since the closure of the Blue Bell. There is not as much antisocial behaviour due to drink. The sale of alcohol to minors has all but ceased. The area is well served by a local shopping parade which is the centre of shopping for the local area. We feel that the problems with selling alcohol to minors are a serious situation. Which can only be exacerbated by the increase in local off-licences?

In a recent study by alcohol concern, the amount of alcohol drunk by children varies according to how many off-licences are in an area where they live. Alcohol concern's chief executive Don Shenker, in a Guardian article on 3rd September 2011 said: "The increase in hospital admissions among young drinkers is a cause for concern and it is particularly worrying that the increased number and concentration of off-licences may be contributing to this. Local areas must have the ability to decide for themselves how many licenced premises they allow..." We already have an off-licence in the Hackenthorpe parade of shops, the shop has been operating for over 20 years, the owners and staff know their local youth and often their parents and are mindful of the effects which alcohol abuse can have, they have strived for a long time to stop underage drinking, another off-licence would only help to exacerbate this problem. Also the street drinkers who have been refused access will find another source to buy their drink.

The site of the application is on Main Street a narrow road going through the village. At the best of times parking is a problem. Opposite the site there are double yellow lines and parking bays which are constantly full. In front of the site there are double yellow lines. Any delivery would have to either park on the yellow lines or in the car park adjacent to the site. Negotiating this would be very difficult with the size of Lorries used for deliveries, also any

car parked there would be effectively blocked in. for the duration of the delivery. The main street is a very busy thoroughfare any delivery parked on the road would prove to be a problem.

Across the road from the premises is sheltered housing for the elderly, the noise generated by the business would indeed be a nuisance to the tranquillity that the residents now enjoy. The constant movement of traffic and people, the congregation of children which seems to go hand in hand with convenience stores would also exacerbate this problem.

In Sheffield City Councils (Conservation Area Appraisal, Hackenthorpe. April 2008)

It states: 7.1 The conservation area has a generally quite atmosphere with few pedestrians. Hackenthorpe suburb's main shopping centre is outside the conservation area.

Should a premises licence be granted this will no longer be the case and pedestrian use of Main Street would increase with the noise and nuisance factor which this would bring?

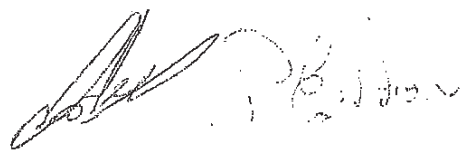

Tim Robinson / Patrick Moon (Directors)

M & R Shops
132- 140 Birley Spa Lane
Hackenthorpe
Sheffield
S12 4EJ



1 Alcohol Concern - One on every corner: The relationship between off-licence density and alcohol harms in young people. (July 2011)



SHEFFIELD CITY COUNCIL
LICENSING SECTION BLOCK C
STANIFORTH ROAD DEPOT
STANIFORTH ROAD
SHEFFIELD
S9 3HD

*Recd
01/11/12
epf*

31st October 2012

Members of the licensing section please find enclosed 60 numbersignatures in objection to
The proposed premises licence at the Blue Bell, 1 Main Street, Hackenthorpe.

BLUE BELL 1 MAIN STREET HACKENTHORPE

OBJECTION TO PREMISES LICENCE.

I OBJECT TO THE APPLICATION FOR THE FOLLOWING REASONS.

THE PREMISES ARE ON A SMALL ROAD WITH LITTLE PARKING AND DOUBLE YELLOW LINES OUTSIDE, THE EXTRA PARKING AND DELIVERY TRAFFIC WILL CREATE A NUISANCE UNTIL LATE NIGHT FOR THE RESIDENTS AND BUSINESSES IN THE AREA, AND WILL ALSO BE A SAFETY ISSUE WITH PEDESTRIANS. UNDERAGE DRINKING HAS ALWAYS BEEN A PROBLEM IN THE AREA AND THIS APPLICATION WILL ONLY HELP TO EXACERBATE THIS.

NAME: I BATTY

ADDRESS: COTHBIGH RD

 SHEFFIELD S12 4HY

BLUE BELL 1 MAIN STREET HACKENTHORPE

OBJECTION TO PREMISES LICENCE.

I OBJECT TO THE APPLICATION FOR THE FOLLOWING REASONS.

THE PREMISES ARE ON A SMALL ROAD WITH LITTLE PARKING AND DOUBLE YELLOW LINES OUTSIDE, THE EXTRA PARKING AND DELIVERY TRAFFIC WILL CREATE A NUISANCE UNTIL LATE NIGHT FOR THE RESIDENTS AND BUSINESSES IN THE AREA, AND WILL ALSO BE A SAFETY ISSUE WITH PEDESTRIANS. UNDERAGE DRINKING HAS ALWAYS BEEN A PROBLEM IN THE AREA AND THIS APPLICATION WILL ONLY HELP TO EXACERBATE THIS.

NAME: Amee Walton
ADDRESS: [REDACTED] Springwater avenue

BLUE BELL 1 MAIN STREET HACKENTHORPE

OBJECTION TO PREMISES LICENCE.

I OBJECT TO THE APPLICATION FOR THE FOLLOWING REASONS.

THE PREMISES ARE ON A SMALL ROAD WITH LITTLE PARKING AND DOUBLE YELLOW LINES OUTSIDE, THE EXTRA PARKING AND DELIVERY TRAFFIC WILL CREATE A NUISANCE UNTIL LATE NIGHT FOR THE RESIDENTS AND BUSINESSES IN THE AREA, AND WILL ALSO BE A SAFETY ISSUE WITH PEDESTRIANS. UNDERAGE DRINKING HAS ALWAYS BEEN A PROBLEM IN THE AREA AND THIS APPLICATION WILL ONLY HELP TO EXACERBATE THIS.

NAME: K BOWER
ADDRESS: BROOKHOUSE CT
HACKENTHORPE
S12 4NN

BLUE BELL 1 MAIN STREET HACKENTHORPE

OBJECTION TO PREMISES LICENCE.

I OBJECT TO THE APPLICATION FOR THE FOLLOWING REASONS.

THE PREMISES ARE ON A SMALL ROAD WITH LITTLE PARKING AND DOUBLE YELLOW LINES OUTSIDE, THE EXTRA PARKING AND DELIVERY TRAFFIC WILL CREATE A NUISANCE UNTIL LATE NIGHT FOR THE RESIDENTS AND BUSINESSES IN THE AREA, AND WILL ALSO BE A SAFETY ISSUE WITH PEDESTRIANS. UNDERAGE DRINKING HAS ALWAYS BEEN A PROBLEM IN THE AREA AND THIS APPLICATION WILL ONLY HELP TO EXACERBATE THIS.

NAME: JOANNA ROBINSON

ADDRESS: VALLEY ROAD
S12 4LH

BLUE BELL 1 MAIN STREET HACKENTHORPE

OBJECTION TO PREMISES LICENCE.

I OBJECT TO THE APPLICATION FOR THE FOLLOWING REASONS.

THE PREMISES ARE ON A SMALL ROAD WITH LITTLE PARKING AND DOUBLE YELLOW LINES OUTSIDE, THE EXTRA PARKING AND DELIVERY TRAFFIC WILL CREATE A NUISANCE UNTIL LATE NIGHT FOR THE RESIDENTS AND BUSINESSES IN THE AREA, AND WILL ALSO BE A SAFETY ISSUE WITH PEDESTRIANS. UNDERAGE DRINKING HAS ALWAYS BEEN A PROBLEM IN THE AREA AND THIS APPLICATION WILL ONLY HELP TO EXACERBATE THIS.

NAME: D. HORST
ADDRESS: DYKES VACU AVENUE
HACKENTHORPE 812

Multiple sets of horizontal lines for additional text or signatures, currently blank.

BLUE BELL 1 MAIN STREET HACKENTHORPE

OBJECTION TO PREMISES LICENCE.

I OBJECT TO THE APPLICATION FOR THE FOLLOWING REASONS.

THE PREMISES ARE ON A SMALL ROAD WITH LITTLE PARKING AND DOUBLE YELLOW LINES OUTSIDE, THE EXTRA PARKING AND DELIVERY TRAFFIC WILL CREATE A NUISANCE UNTIL LATE NIGHT FOR THE RESIDENTS AND BUSINESSES IN THE AREA, AND WILL ALSO BE A SAFETY ISSUE WITH PEDESTRIANS. UNDERAGE DRINKING HAS ALWAYS BEEN A PROBLEM IN THE AREA AND THIS APPLICATION WILL ONLY HELP TO EXACERBATE THIS.

NAME: R. Fisher ROY FISHER

ADDRESS: HUTTON CROFT
SHEFFIELD S12 4LY

Multiple sets of horizontal lines for additional text or signatures.

BLUE BELL 1 MAIN STREET HACKENTHORPE

OBJECTION TO PREMISES LICENCE.

I OBJECT TO THE APPLICATION FOR THE FOLLOWING REASONS.

THE PREMISES ARE ON A SMALL ROAD WITH LITTLE PARKING AND DOUBLE YELLOW LINES OUTSIDE, THE EXTRA PARKING AND DELIVERY TRAFFIC WILL CREATE A NUISANCE UNTIL LATE NIGHT FOR THE RESIDENTS AND BUSINESSES IN THE AREA, AND WILL ALSO BE A SAFETY ISSUE WITH PEDESTRIANS. UNDERAGE DRINKING HAS ALWAYS BEEN A PROBLEM IN THE AREA AND THIS APPLICATION WILL ONLY HELP TO EXACERBATE THIS.

NAME: ALAN CHARLES BOYD
ADDRESS: [REDACTED] main street HACKENTHORPE

BLUE BELL 1 MAIN STREET HACKENTHORPE

OBJECTION TO PREMISES LICENCE.

I OBJECT TO THE APPLICATION FOR THE FOLLOWING REASONS.

THE PREMISES ARE ON A SMALL ROAD WITH LITTLE PARKING AND DOUBL
YELLOW LINES OUTSIDE, THE EXTRA PARKING AND DELIVERY TRAFFIC WIL
CREATE A NUISANCE UNTIL LATE NIGHT FOR THE RESIDENTS AND
BUSINESSES IN THE AREA, AND WILL ALSO BE A SAFETY ISSUE WITH
PEDESTRIANS. UNDERAGE DRINKING HAS ALWAYS BEEN A PROBLEM IN TH
AREA AND THIS APPLICATION WILL ONLY HELP TO EXACERBATE THIS.

NAME: M CAMMACK

ADDRESS: FOURTEENS DOME
SIR

BLUE BELL 1 MAIN STREET HACKENTHORPE

OBJECTION TO PREMISES LICENCE.

I OBJECT TO THE APPLICATION FOR THE FOLLOWING REASONS.
THE PREMISES ARE ON A SMALL ROAD WITH LITTLE PARKING AND DOUBLE
YELLOW LINES OUTSIDE, THE EXTRA PARKING AND DELIVERY TRAFFIC WILL
CREATE A NUISANCE UNTIL LATE NIGHT FOR THE RESIDENTS AND
BUSINESSES IN THE AREA, AND WILL ALSO BE A SAFETY ISSUE WITH
PEDESTRIANS. UNDERAGE DRINKING HAS ALWAYS BEEN A PROBLEM IN THE
AREA AND THIS APPLICATION WILL ONLY HELP TO EXACERBATE THIS.

NAME: Chris Hemmison
ADDRESS: [REDACTED] Carr Forge Close
812 LK4

Multiple sets of horizontal lines for additional text or signatures, currently blank.

BLUE BELL 1 MAIN STREET HACKENTHORPE

OBJECTION TO PREMISES LICENCE.

I OBJECT TO THE APPLICATION FOR THE FOLLOWING REASONS.

THE PREMISES ARE ON A SMALL ROAD WITH LITTLE PARKING AND DOUBLE YELLOW LINES OUTSIDE, THE EXTRA PARKING AND DELIVERY TRAFFIC WILL CREATE A NUISANCE UNTIL LATE NIGHT FOR THE RESIDENTS AND BUSINESSES IN THE AREA, AND WILL ALSO BE A SAFETY ISSUE WITH PEDESTRIANS. UNDERAGE DRINKING HAS ALWAYS BEEN A PROBLEM IN THE AREA AND THIS APPLICATION WILL ONLY HELP TO EXACERBATE THIS.

NAME: Sarah Stafford

ADDRESS: Farm View Gardens
Sheffield S12 4JD.

BLUE BELL 1 MAIN STREET HACKENTHORPE

OBJECTION TO PREMISES LICENCE.

I OBJECT TO THE APPLICATION FOR THE FOLLOWING REASONS.

THE PREMISES ARE ON A SMALL ROAD WITH LITTLE PARKING AND DOUBLE YELLOW LINES OUTSIDE, THE EXTRA PARKING AND DELIVERY TRAFFIC WILL CREATE A NUISANCE UNTIL LATE NIGHT FOR THE RESIDENTS AND BUSINESSES IN THE AREA, AND WILL ALSO BE A SAFETY ISSUE WITH PEDESTRIANS. UNDERAGE DRINKING HAS ALWAYS BEEN A PROBLEM IN THE AREA AND THIS APPLICATION WILL ONLY HELP TO EXACERBATE THIS.

NAME: MRS D. ASTTON,

ADDRESS: BIRLEY SPA LANE, HACKENTHORPE
STAFFORD ST. W. LEA

BLUE BELL 1 MAIN STREET HACKENTHORPE

OBJECTION TO PREMISES LICENCE.

I OBJECT TO THE APPLICATION FOR THE FOLLOWING REASONS.

THE PREMISES ARE ON A SMALL ROAD WITH LITTLE PARKING AND DOUBLE YELLOW LINES OUTSIDE, THE EXTRA PARKING AND DELIVERY TRAFFIC WILL CREATE A NUISANCE UNTIL LATE NIGHT FOR THE RESIDENTS AND BUSINESSES IN THE AREA, AND WILL ALSO BE A SAFETY ISSUE WITH PEDESTRIANS. UNDERAGE DRINKING HAS ALWAYS BEEN A PROBLEM IN THE AREA AND THIS APPLICATION WILL ONLY HELP TO EXACERBATE THIS.

NAME: Patrick Brown
ADDRESS: [REDACTED] CAM FORBES ROAD
S. 124RH

BLUE BELL 1 MAIN STREET HACKENTHORPE

OBJECTION TO PREMISES LICENCE.

I OBJECT TO THE APPLICATION FOR THE FOLLOWING REASONS.

THE PREMISES ARE ON A SMALL ROAD WITH LITTLE PARKING AND DOUBLE YELLOW LINES OUTSIDE, THE EXTRA PARKING AND DELIVERY TRAFFIC WILL CREATE A NUISANCE UNTIL LATE NIGHT FOR THE RESIDENTS AND BUSINESSES IN THE AREA, AND WILL ALSO BE A SAFETY ISSUE WITH PEDESTRIANS. UNDERAGE DRINKING HAS ALWAYS BEEN A PROBLEM IN THE AREA AND THIS APPLICATION WILL ONLY HELP TO EXACERBATE THIS.

NAME: Claire Crookes

ADDRESS: Four Wells Drive

Sheffield S12 4JB

BLUE BELL 1 MAIN STREET HACKENTHORPE

OBJECTION TO PREMISES LICENCE.

I OBJECT TO THE APPLICATION FOR THE FOLLOWING REASONS.

THE PREMISES ARE ON A SMALL ROAD WITH LITTLE PARKING AND DOUBLE YELLOW LINES OUTSIDE, THE EXTRA PARKING AND DELIVERY TRAFFIC WILL CREATE A NUISANCE UNTIL LATE NIGHT FOR THE RESIDENTS AND BUSINESSES IN THE AREA, AND WILL ALSO BE A SAFETY ISSUE WITH PEDESTRIANS. UNDERAGE DRINKING HAS ALWAYS BEEN A PROBLEM IN THE AREA AND THIS APPLICATION WILL ONLY HELP TO EXACERBATE THIS.

NAME: FAYE ASKHAM

ADDRESS: ■ DYKE VACE PLACE

S12 4EP

BLUE BELL 1 MAIN STREET HACKENTHORPE

OBJECTION TO PREMISES LICENCE.

I OBJECT TO THE APPLICATION FOR THE FOLLOWING REASONS.

THE PREMISES ARE ON A SMALL ROAD WITH LITTLE PARKING AND DOUBLE YELLOW LINES OUTSIDE, THE EXTRA PARKING AND DELIVERY TRAFFIC WILL CREATE A NUISANCE UNTIL LATE NIGHT FOR THE RESIDENTS AND BUSINESSES IN THE AREA, AND WILL ALSO BE A SAFETY ISSUE WITH PEDESTRIANS. UNDERAGE DRINKING HAS ALWAYS BEEN A PROBLEM IN THE AREA AND THIS APPLICATION WILL ONLY HELP TO EXACERBATE THIS.

NAME: Rachel Wright
ADDRESS: [redacted] carter lodge place
Hackenthorpe, Sheffield,

BLUE BELL 1 MAIN STREET HACKENTHORPE

OBJECTION TO PREMISES LICENCE.

I OBJECT TO THE APPLICATION FOR THE FOLLOWING REASONS.

THE PREMISES ARE ON A SMALL ROAD WITH LITTLE PARKING AND DOUBLE YELLOW LINES OUTSIDE, THE EXTRA PARKING AND DELIVERY TRAFFIC WILL CREATE A NUISANCE UNTIL LATE NIGHT FOR THE RESIDENTS AND BUSINESSES IN THE AREA, AND WILL ALSO BE A SAFETY ISSUE WITH PEDESTRIANS. UNDERAGE DRINKING HAS ALWAYS BEEN A PROBLEM IN THE AREA AND THIS APPLICATION WILL ONLY HELP TO EXACERBATE THIS.

NAME: JOHN PROCTOR
ADDRESS: DEZVES PLACE HACKENTHORPE

Empty lined area for additional text or signature.



BLUE BELL 1 MAIN STREET HACKENTHORPE

OBJECTION TO PREMISES LICENCE.

I OBJECT TO THE APPLICATION FOR THE FOLLOWING REASONS.

THE PREMISES ARE ON A SMALL ROAD WITH LITTLE PARKING AND DOUBLE YELLOW LINES OUTSIDE, THE EXTRA PARKING AND DELIVERY TRAFFIC WILL CREATE A NUISANCE UNTIL LATE NIGHT FOR THE RESIDENTS AND BUSINESSES IN THE AREA, AND WILL ALSO BE A SAFETY ISSUE WITH PEDESTRIANS. UNDERAGE DRINKING HAS ALWAYS BEEN A PROBLEM IN THE AREA AND THIS APPLICATION WILL ONLY HELP TO EXACERBATE THIS.

NAME: H. Dudley

ADDRESS: [Redacted] Dyke Vale way
512 QEZ

Multiple horizontal lines for additional text or signature.





BLUE BELL 1 MAIN STREET HACKENTHORPE

OBJECTION TO PREMISES LICENCE.

I OBJECT TO THE APPLICATION FOR THE FOLLOWING REASONS.

THE PREMISES ARE ON A SMALL ROAD WITH LITTLE PARKING AND DOUBLE YELLOW LINES OUTSIDE, THE EXTRA PARKING AND DELIVERY TRAFFIC WILL CREATE A NUISANCE UNTIL LATE NIGHT FOR THE RESIDENTS AND BUSINESSES IN THE AREA, AND WILL ALSO BE A SAFETY ISSUE WITH PEDESTRIANS. UNDERAGE DRINKING HAS ALWAYS BEEN A PROBLEM IN THE AREA AND THIS APPLICATION WILL ONLY HELP TO EXACERBATE THIS.

NAME: P. Barstey

ADDRESS: Can Forge RD.

Multiple horizontal lines for additional text or signature.



BLUE BELL 1 MAIN STREET HACKENTHORPE



OBJECTION TO PREMISES LICENCE.

I OBJECT TO THE APPLICATION FOR THE FOLLOWING REASONS.

THE PREMISES ARE ON A SMALL ROAD WITH LITTLE PARKING AND DOUBLE YELLOW LINES OUTSIDE, THE EXTRA PARKING AND DELIVERY TRAFFIC WILL CREATE A NUISANCE UNTIL LATE NIGHT FOR THE RESIDENTS AND BUSINESSES IN THE AREA, AND WILL ALSO BE A SAFETY ISSUE WITH PEDESTRIANS. UNDERAGE DRINKING HAS ALWAYS BEEN A PROBLEM IN THE AREA AND THIS APPLICATION WILL ONLY HELP TO EXACERBATE THIS.

NAME: Pat Beal
ADDRESS: [Redacted] Four Wells Drive
S12 4JB

Four sets of horizontal lines for additional text or signatures.

BLUE BELL 1 MAIN STREET HACKENTHORPE



OBJECTION TO PREMISES LICENCE.

I OBJECT TO THE APPLICATION FOR THE FOLLOWING REASONS.

THE PREMISES ARE ON A SMALL ROAD WITH LITTLE PARKING AND DOUBLE YELLOW LINES OUTSIDE, THE EXTRA PARKING AND DELIVERY TRAFFIC WILL CREATE A NUISANCE UNTIL LATE NIGHT FOR THE RESIDENTS AND BUSINESSES IN THE AREA, AND WILL ALSO BE A SAFETY ISSUE WITH PEDESTRIANS. UNDERAGE DRINKING HAS ALWAYS BEEN A PROBLEM IN THE AREA AND THIS APPLICATION WILL ONLY HELP TO EXACERBATE THIS.

NAME: CRAIG M GEE

ADDRESS: East of lake crescent 12



BLUE BELL 1 MAIN STREET HACKENTHORPE

OBJECTION TO PREMISES LICENCE.

I OBJECT TO THE APPLICATION FOR THE FOLLOWING REASONS.

THE PREMISES ARE ON A SMALL ROAD WITH LITTLE PARKING AND DOUBLE YELLOW LINES OUTSIDE, THE EXTRA PARKING AND DELIVERY TRAFFIC WILL CREATE A NUISANCE UNTIL LATE NIGHT FOR THE RESIDENTS AND BUSINESSES IN THE AREA, AND WILL ALSO BE A SAFETY ISSUE WITH PEDESTRIANS. UNDERAGE DRINKING HAS ALWAYS BEEN A PROBLEM IN THE AREA AND THIS APPLICATION WILL ONLY HELP TO EXACERBATE THIS,

NAME: clenny marshall
ADDRESS: [redacted] COTWELL CRES
Hackenthorpe SR



BLUE BELL 1 MAIN STREET HACKENTHORPE

OBJECTION TO PREMISES LICENCE.

I OBJECT TO THE APPLICATION FOR THE FOLLOWING REASONS.

THE PREMISES ARE ON A SMALL ROAD WITH LITTLE PARKING AND DOUBLE YELLOW LINES OUTSIDE, THE EXTRA PARKING AND DELIVERY TRAFFIC WILL CREATE A NUISANCE UNTIL LATE NIGHT FOR THE RESIDENTS AND BUSINESSES IN THE AREA, AND WILL ALSO BE A SAFETY ISSUE WITH PEDESTRIANS. UNDERAGE DRINKING HAS ALWAYS BEEN A PROBLEM IN THE AREA AND THIS APPLICATION WILL ONLY HELP TO EXACERBATE THIS.

NAME: Linzi West.
ADDRESS: [Redacted] Bury Spa Lane
Sheffield S12 4BA.

Multiple horizontal lines for additional text or signature.



BLUE BELL 1 MAIN STREET HACKENTHORPE

OBJECTION TO PREMISES LICENCE.

I OBJECT TO THE APPLICATION FOR THE FOLLOWING REASONS.

THE PREMISES ARE ON A SMALL ROAD WITH LITTLE PARKING AND DOUBLE YELLOW LINES OUTSIDE, THE EXTRA PARKING AND DELIVERY TRAFFIC WILL CREATE A NUISANCE UNTIL LATE NIGHT FOR THE RESIDENTS AND BUSINESSES IN THE AREA, AND WILL ALSO BE A SAFETY ISSUE WITH PEDESTRIANS. UNDERAGE DRINKING HAS ALWAYS BEEN A PROBLEM IN THE AREA AND THIS APPLICATION WILL ONLY HELP TO EXACERBATE THIS.

NAME: D. WATSON

ADDRESS: COSCEY CHS

Multiple horizontal lines for additional text or signature, currently blank.





BLUE BELL 1 MAIN STREET HACKENTHORPE

OBJECTION TO PREMISES LICENCE.

I OBJECT TO THE APPLICATION FOR THE FOLLOWING REASONS.

THE PREMISES ARE ON A SMALL ROAD WITH LITTLE PARKING AND DOUBLE YELLOW LINES OUTSIDE, THE EXTRA PARKING AND DELIVERY TRAFFIC WILL CREATE A NUISANCE UNTIL LATE NIGHT FOR THE RESIDENTS AND BUSINESSES IN THE AREA, AND WILL ALSO BE A SAFETY ISSUE WITH PEDESTRIANS. UNDERAGE DRINKING HAS ALWAYS BEEN A PROBLEM IN THE AREA AND THIS APPLICATION WILL ONLY HELP TO EXACERBATE THIS.

NAME: A TIDGOWEL

ADDRESS: [REDACTED] COLBISH DRIVE
S12 4HW

Multiple horizontal lines for additional text or signature, currently blank.



BLUE BELL 1 MAIN STREET HACKENTHORPE



OBJECTION TO PREMISES LICENCE.

I OBJECT TO THE APPLICATION FOR THE FOLLOWING REASONS.
THE PREMISES ARE ON A SMALL ROAD WITH LITTLE PARKING AND DOUBLE YELLOW LINES OUTSIDE, THE EXTRA PARKING AND DELIVERY TRAFFIC WILL CREATE A NUISANCE UNTIL LATE NIGHT FOR THE RESIDENTS AND BUSINESSES IN THE AREA, AND WILL ALSO BE A SAFETY ISSUE WITH PEDESTRIANS. UNDERAGE DRINKING HAS ALWAYS BEEN A PROBLEM IN THE AREA AND THIS APPLICATION WILL ONLY HELP TO EXACERBATE THIS.

NAME: P. Taylor
ADDRESS: [Redacted] Bingley Spa Lane
SHOPTON SIC 489

Multiple horizontal lines for additional text or signatures, currently blank.



BLUE BELL 1 MAIN STREET HACKENTHORPE



OBJECTION TO PREMISES LICENCE.

I OBJECT TO THE APPLICATION FOR THE FOLLOWING REASONS.

THE PREMISES ARE ON A SMALL ROAD WITH LITTLE PARKING AND DOUBLE YELLOW LINES OUTSIDE, THE EXTRA PARKING AND DELIVERY TRAFFIC WILL CREATE A NUISANCE UNTIL LATE NIGHT FOR THE RESIDENTS AND BUSINESSES IN THE AREA, AND WILL ALSO BE A SAFETY ISSUE WITH PEDESTRIANS. UNDERAGE DRINKING HAS ALWAYS BEEN A PROBLEM IN THE AREA AND THIS APPLICATION WILL ONLY HELP TO EXACERBATE THIS.

NAME: MR S. MARRERS

ADDRESS: [REDACTED] BIRLEY SPA LANE
SHEFFIELD S12 4BE

Multiple horizontal lines for additional text or signature, currently blank.

BLUE BELL 1 MAIN STREET HACKENTHORPE



OBJECTION TO PREMISES LICENCE.

I OBJECT TO THE APPLICATION FOR THE FOLLOWING REASONS.

THE PREMISES ARE ON A SMALL ROAD WITH LITTLE PARKING AND DOUBLE YELLOW LINES OUTSIDE, THE EXTRA PARKING AND DELIVERY TRAFFIC WILL CREATE A NUISANCE UNTIL LATE NIGHT FOR THE RESIDENTS AND BUSINESSES IN THE AREA, AND WILL ALSO BE A SAFETY ISSUE WITH PEDESTRIANS. UNDERAGE DRINKING HAS ALWAYS BEEN A PROBLEM IN THE AREA AND THIS APPLICATION WILL ONLY HELP TO EXACERBATE THIS.

NAME: R. McALLEN

ADDRESS: [REDACTED] HARWOOD GARDENS S20 7CE

Multiple horizontal lines for additional text or signature, currently blank.

BLUE BELL 1 MAIN STREET HACKENTHORPE

OBJECTION TO PREMISES LICENCE.

I OBJECT TO THE APPLICATION FOR THE FOLLOWING REASONS.

THE PREMISES ARE ON A SMALL ROAD WITH LITTLE PARKING AND DOUBLE YELLOW LINES OUTSIDE, THE EXTRA PARKING AND DELIVERY TRAFFIC WILL CREATE A NUISANCE UNTIL LATE NIGHT FOR THE RESIDENTS AND BUSINESSES IN THE AREA, AND WILL ALSO BE A SAFETY ISSUE WITH PEDESTRIANS. UNDERAGE DRINKING HAS ALWAYS BEEN A PROBLEM IN THE AREA AND THIS APPLICATION WILL ONLY HELP TO EXACERBATE THIS.

NAME: PAT TRAVIS
ADDRESS: [REDACTED] BIRLEY SPA LANE
HACKENTHORPE S12 4BP



BLUE BELL 1 MAIN STREET HACKENTHORPE

OBJECTION TO PREMISES LICENCE.

I OBJECT TO THE APPLICATION FOR THE FOLLOWING REASONS.

THE PREMISES ARE ON A SMALL ROAD WITH LITTLE PARKING AND DOUBLE YELLOW LINES OUTSIDE, THE EXTRA PARKING AND DELIVERY TRAFFIC WILL CREATE A NUISANCE UNTIL LATE NIGHT FOR THE RESIDENTS AND BUSINESSES IN THE AREA, AND WILL ALSO BE A SAFETY ISSUE WITH PEDESTRIANS. UNDERAGE DRINKING HAS ALWAYS BEEN A PROBLEM IN THE AREA AND THIS APPLICATION WILL ONLY HELP TO EXACERBATE THIS.

NAME: T. Ranso
ADDRESS: BIRLEY POA LANE
SHORE STREET

Multiple horizontal lines for additional text or comments, currently blank.



BLUE BELL 1 MAIN STREET HACKENTHORPE

OBJECTION TO PREMISES LICENCE.

I OBJECT TO THE APPLICATION FOR THE FOLLOWING REASONS.

THE PREMISES ARE ON A SMALL ROAD WITH LITTLE PARKING AND DOUBLE YELLOW LINES OUTSIDE, THE EXTRA PARKING AND DELIVERY TRAFFIC WILL CREATE A NUISANCE UNTIL LATE NIGHT FOR THE RESIDENTS AND BUSINESSES IN THE AREA, AND WILL ALSO BE A SAFETY ISSUE WITH PEDESTRIANS. UNDERAGE DRINKING HAS ALWAYS BEEN A PROBLEM IN THE AREA AND THIS APPLICATION WILL ONLY HELP TO EXACERBATE THIS.

NAME: P Moon
ADDRESS: [REDACTED] DUNLEY POA LANE
S12 4ET

Multiple horizontal lines for additional text or signature.

BLUE BELL 1 MAIN STREET HACKENTHORPE

OBJECTION TO PREMISES LICENCE.

I OBJECT TO THE APPLICATION FOR THE FOLLOWING REASONS.

THE PREMISES ARE ON A SMALL ROAD WITH LITTLE PARKING AND DOUBLE YELLOW LINES OUTSIDE, THE EXTRA PARKING AND DELIVERY TRAFFIC WILL CREATE A NUISANCE UNTIL LATE NIGHT FOR THE RESIDENTS AND BUSINESSES IN THE AREA, AND WILL ALSO BE A SAFETY ISSUE WITH PEDESTRIANS. UNDERAGE DRINKING HAS ALWAYS BEEN A PROBLEM IN THE AREA AND THIS APPLICATION WILL ONLY HELP TO EXACERBATE THIS.

NAME: S. MCANES
ADDRESS: [REDACTED] JENNYN AVE
HACKENTHORPE.



BLUE BELL 1 MAIN STREET HACKENTHORPE

OBJECTION TO PREMISES LICENCE.

I OBJECT TO THE APPLICATION FOR THE FOLLOWING REASONS.

THE PREMISES ARE ON A SMALL ROAD WITH LITTLE PARKING AND DOUBLE YELLOW LINES OUTSIDE, THE EXTRA PARKING AND DELIVERY TRAFFIC WILL CREATE A NUISANCE UNTIL LATE NIGHT FOR THE RESIDENTS AND BUSINESSES IN THE AREA, AND WILL ALSO BE A SAFETY ISSUE WITH PEDESTRIANS. UNDERAGE DRINKING HAS ALWAYS BEEN A PROBLEM IN THE AREA AND THIS APPLICATION WILL ONLY HELP TO EXACERBATE THIS.

NAME: MRS G KEMSHALL

ADDRESS: ■ CABR FORGE TERR
HACKENTHORPE

Multiple sets of horizontal lines for additional text or signatures, currently blank.



BLUE BELL 1 MAIN STREET HACKENTHORPE

OBJECTION TO PREMISES LICENCE.

I OBJECT TO THE APPLICATION FOR THE FOLLOWING REASONS.

THE PREMISES ARE ON A SMALL ROAD WITH LITTLE PARKING AND DOUBLE YELLOW LINES OUTSIDE, THE EXTRA PARKING AND DELIVERY TRAFFIC WILL CREATE A NUISANCE UNTIL LATE NIGHT FOR THE RESIDENTS AND BUSINESSES IN THE AREA, AND WILL ALSO BE A SAFETY ISSUE WITH PEDESTRIANS. UNDERAGE DRINKING HAS ALWAYS BEEN A PROBLEM IN THE AREA AND THIS APPLICATION WILL ONLY HELP TO EXACERBATE THIS.

NAME: Alex Standish
ADDRESS: [Redacted] Rainbow Way
Sheffield 12





BLUE BELL 1 MAIN STREET HACKENTHORPE

OBJECTION TO PREMISES LICENCE.

I OBJECT TO THE APPLICATION FOR THE FOLLOWING REASONS.

THE PREMISES ARE ON A SMALL ROAD WITH LITTLE PARKING AND DOUBLE YELLOW LINES OUTSIDE, THE EXTRA PARKING AND DELIVERY TRAFFIC WILL CREATE A NUISANCE UNTIL LATE NIGHT FOR THE RESIDENTS AND BUSINESSES IN THE AREA, AND WILL ALSO BE A SAFETY ISSUE WITH PEDESTRIANS. UNDERAGE DRINKING HAS ALWAYS BEEN A PROBLEM IN THE AREA AND THIS APPLICATION WILL ONLY HELP TO EXACERBATE THIS.

NAME: Dona

ADDRESS: Carr Forge Road.

Multiple horizontal lines for additional text or signature, currently blank.

BLUE BELL 1 MAIN STREET HACKENTHORPE

OBJECTION TO PREMISES LICENCE

I OBJECT TO THE APPLICATION FOR THE FOLLOWING REASONS:

THE PREMISES ARE ON A SMALL ROAD WITH LITTLE PARKING AND DOUBLE YELLOW LINES OUTSIDE. THE EXTRA PARKING AND DELIVERY TRAFFIC WILL CREATE A NUISANCE UNTIL LATE NIGHT FOR THE RESIDENTS AND BUSINESSES IN THE AREA, AND WILL ALSO BE A SAFETY ISSUE WITH PEDESTRIANS. UNDERAGE DRINKING HAS ALWAYS BEEN A PROBLEM IN THE AREA AND THIS APPLICATION WILL ONLY HELP TO EXACERBATE THIS.

NAME: Dianne Gregory
ADDRESS: Spa View Terrace
Hackenthorpe

BLUE BELL 1 MAIN STREET HACKENTHORPE

OBJECTION TO PREMISES LICENCE.

I OBJECT TO THE APPLICATION FOR THE FOLLOWING REASONS.

THE PREMISES ARE ON A SMALL ROAD WITH LITTLE PARKING AND DOUBLE YELLOW LINES OUTSIDE, THE EXTRA PARKING AND DELIVERY TRAFFIC WILL CREATE A NUISANCE UNTIL LATE NIGHT FOR THE RESIDENTS AND BUSINESSES IN THE AREA, AND WILL ALSO BE A SAFETY ISSUE WITH PEDESTRIANS. UNDERAGE DRINKING HAS ALWAYS BEEN A PROBLEM IN THE AREA AND THIS APPLICATION WILL ONLY HELP TO EXACERBATE THIS.

NAME: CHRYSL BELLWORTH

ADDRESS: [REDACTED] BIRLEY SPA LANE

Multiple horizontal lines for additional text or signature.



BLUE BELL 1 MAIN STREET HACKENTHORPE

OBJECTION TO PREMISES LICENCE.

I OBJECT TO THE APPLICATION FOR THE FOLLOWING REASONS.

THE PREMISES ARE ON A SMALL ROAD WITH LITTLE PARKING AND DOUBLE YELLOW LINES OUTSIDE, THE EXTRA PARKING AND DELIVERY TRAFFIC WILL CREATE A NUISANCE UNTIL LATE NIGHT FOR THE RESIDENTS AND BUSINESSES IN THE AREA, AND WILL ALSO BE A SAFETY ISSUE WITH PEDESTRIANS. UNDERAGE DRINKING HAS ALWAYS BEEN A PROBLEM IN THE AREA AND THIS APPLICATION WILL ONLY HELP TO EXACERBATE THIS.

NAME: S RIPPON

ADDRESS: Carter lodge Walk

Multiple horizontal lines for additional text or signature.



BLUE BELL 1 MAIN STREET HACKENTHORPE

OBJECTION TO PREMISES LICENCE.

I OBJECT TO THE APPLICATION FOR THE FOLLOWING REASONS.

THE PREMISES ARE ON A SMALL ROAD WITH LITTLE PARKING AND DOUBLE YELLOW LINES OUTSIDE, THE EXTRA PARKING AND DELIVERY TRAFFIC WILL CREATE A NUISANCE UNTIL LATE NIGHT FOR THE RESIDENTS AND BUSINESSES IN THE AREA, AND WILL ALSO BE A SAFETY ISSUE WITH PEDESTRIANS. UNDERAGE DRINKING HAS ALWAYS BEEN A PROBLEM IN THE AREA AND THIS APPLICATION WILL ONLY HELP TO EXACERBATE THIS.

NAME: Karlene Smith

ADDRESS: 1 Coleridge Crescent
Hackenthorpe

Multiple horizontal lines for additional text or signatures, currently blank.

BLUE BELL 1 MAIN STREET HACKENTHORPE



OBJECTION TO PREMISES LICENCE.

I OBJECT TO THE APPLICATION FOR THE FOLLOWING REASONS.

THE PREMISES ARE ON A SMALL ROAD WITH LITTLE PARKING AND DOUBLE YELLOW LINES OUTSIDE, THE EXTRA PARKING AND DELIVERY TRAFFIC WILL CREATE A NUISANCE UNTIL LATE NIGHT FOR THE RESIDENTS AND BUSINESSES IN THE AREA, AND WILL ALSO BE A SAFETY ISSUE WITH PEDESTRIANS. UNDERAGE DRINKING HAS ALWAYS BEEN A PROBLEM IN THE AREA AND THIS APPLICATION WILL ONLY HELP TO EXACERBATE THIS.

NAME: Alister
ADDRESS: Sirfars

Multiple horizontal lines for additional text or signature.



BLUE BELL 1 MAIN STREET HACKENTHORPE

OBJECTION TO PREMISES LICENCE.

I OBJECT TO THE APPLICATION FOR THE FOLLOWING REASONS.

THE PREMISES ARE ON A SMALL ROAD WITH LITTLE PARKING AND DOUBLE YELLOW LINES OUTSIDE, THE EXTRA PARKING AND DELIVERY TRAFFIC WILL CREATE A NUISANCE UNTIL LATE NIGHT FOR THE RESIDENTS AND BUSINESSES IN THE AREA, AND WILL ALSO BE A SAFETY ISSUE WITH PEDESTRIANS. UNDERAGE DRINKING HAS ALWAYS BEEN A PROBLEM IN THE AREA AND THIS APPLICATION WILL ONLY HELP TO EXACERBATE THIS.

NAME: Joan

ADDRESS: [redacted] Colwyn drive





BLUE BELL 1 MAIN STREET HACKENTHORPE

OBJECTION TO PREMISES LICENCE.

I OBJECT TO THE APPLICATION FOR THE FOLLOWING REASONS.

THE PREMISES ARE ON A SMALL ROAD WITH LITTLE PARKING AND DOUBLE YELLOW LINES OUTSIDE, THE EXTRA PARKING AND DELIVERY TRAFFIC WILL CREATE A NUISANCE UNTIL LATE NIGHT FOR THE RESIDENTS AND BUSINESSES IN THE AREA, AND WILL ALSO BE A SAFETY ISSUE WITH PEDESTRIANS. UNDERAGE DRINKING HAS ALWAYS BEEN A PROBLEM IN THE AREA AND THIS APPLICATION WILL ONLY HELP TO EXACERBATE THIS.

NAME: James Robles
ADDRESS: [REDACTED] High Greave, Ecclefield S5 99Q

Multiple horizontal lines for additional text or signatures, currently blank.





BLUE BELL 1 MAIN STREET HACKENTHORPE

OBJECTION TO PREMISES LICENCE.

I OBJECT TO THE APPLICATION FOR THE FOLLOWING REASONS.

THE PREMISES ARE ON A SMALL ROAD WITH LITTLE PARKING AND DOUBLE YELLOW LINES OUTSIDE, THE EXTRA PARKING AND DELIVERY TRAFFIC WILL CREATE A NUISANCE UNTIL LATE NIGHT FOR THE RESIDENTS AND BUSINESSES IN THE AREA, AND WILL ALSO BE A SAFETY ISSUE WITH PEDESTRIANS. UNDERAGE DRINKING HAS ALWAYS BEEN A PROBLEM IN THE AREA AND THIS APPLICATION WILL ONLY HELP TO EXACERBATE THIS.

NAME: J. Vahay
ADDRESS: [REDACTED] Birley Spa Inn
512-4Bq

Multiple sets of horizontal lines for additional text or signatures, currently blank.

BLUE BELL 1 MAIN STREET HACKENTHORPE

OBJECTION TO PREMISES LICENCE.

I OBJECT TO THE APPLICATION FOR THE FOLLOWING REASONS.

THE PREMISES ARE ON A SMALL ROAD WITH LITTLE PARKING AND DOUBLE YELLOW LINES OUTSIDE, THE EXTRA PARKING AND DELIVERY TRAFFIC WILL CREATE A NUISANCE UNTIL LATE NIGHT FOR THE RESIDENTS AND BUSINESSES IN THE AREA, AND WILL ALSO BE A SAFETY ISSUE WITH PEDESTRIANS. UNDERAGE DRINKING HAS ALWAYS BEEN A PROBLEM IN THE AREA AND THIS APPLICATION WILL ONLY HELP TO EXACERBATE THIS.

NAME: J ROBERTT

ADDRESS: [REDACTED] DELVES TERRACE
SIR WAL

BLUE BELL 1 MAIN STREET HACKENTHORPE

OBJECTION TO PREMISES LICENCE.

I OBJECT TO THE APPLICATION FOR THE FOLLOWING REASONS.

THE PREMISES ARE ON A SMALL ROAD WITH LITTLE PARKING AND DOUBLE YELLOW LINES OUTSIDE, THE EXTRA PARKING AND DELIVERY TRAFFIC WILL CREATE A NUISANCE UNTIL LATE NIGHT FOR THE RESIDENTS AND BUSINESSES IN THE AREA, AND WILL ALSO BE A SAFETY ISSUE WITH PEDESTRIANS. UNDERAGE DRINKING HAS ALWAYS BEEN A PROBLEM IN THE AREA AND THIS APPLICATION WILL ONLY HELP TO EXACERBATE THIS.

NAME: S. Williams

ADDRESS: [REDACTED] JEROME DRIVE

Multiple horizontal lines for additional text or comments, currently blank.



BLUE BELL 1 MAIN STREET HACKENTHORPE

OBJECTION TO PREMISES LICENCE.

I OBJECT TO THE APPLICATION FOR THE FOLLOWING REASONS.

THE PREMISES ARE ON A SMALL ROAD WITH LITTLE PARKING AND DOUBLE YELLOW LINES OUTSIDE, THE EXTRA PARKING AND DELIVERY TRAFFIC WILL CREATE A NUISANCE UNTIL LATE NIGHT FOR THE RESIDENTS AND BUSINESSES IN THE AREA, AND WILL ALSO BE A SAFETY ISSUE WITH PEDESTRIANS. UNDERAGE DRINKING HAS ALWAYS BEEN A PROBLEM IN THE AREA AND THIS APPLICATION WILL ONLY HELP TO EXACERBATE THIS.

NAME: TRAVIS

ADDRESS: ■ Farm View Drive
S12 4JE

BLUE BELL 1 MAIN STREET HACKENTHORPE

OBJECTION TO PREMISES LICENCE.



I OBJECT TO THE APPLICATION FOR THE FOLLOWING REASONS.

THE PREMISES ARE ON A SMALL ROAD WITH LITTLE PARKING AND DOUBLE YELLOW LINES OUTSIDE, THE EXTRA PARKING AND DELIVERY TRAFFIC WILL CREATE A NUISANCE UNTIL LATE NIGHT FOR THE RESIDENTS AND BUSINESSES IN THE AREA, AND WILL ALSO BE A SAFETY ISSUE WITH PEDESTRIANS. UNDERAGE DRINKING HAS ALWAYS BEEN A PROBLEM IN THE AREA AND THIS APPLICATION WILL ONLY HELP TO EXACERBATE THIS.

NAME: Ben Ashworth

ADDRESS: 1 Cotleigh Avenue
S12 4HQ



BLUE BELL 1 MAIN STREET HACKENTHORPE

OBJECTION TO PREMISES LICENCE.

I OBJECT TO THE APPLICATION FOR THE FOLLOWING REASONS.

THE PREMISES ARE ON A SMALL ROAD WITH LITTLE PARKING AND DOUBLE YELLOW LINES OUTSIDE, THE EXTRA PARKING AND DELIVERY TRAFFIC WILL CREATE A NUISANCE UNTIL LATE NIGHT FOR THE RESIDENTS AND BUSINESSES IN THE AREA, AND WILL ALSO BE A SAFETY ISSUE WITH PEDESTRIANS. UNDERAGE DRINKING HAS ALWAYS BEEN A PROBLEM IN THE AREA AND THIS APPLICATION WILL ONLY HELP TO EXACERBATE THIS.

NAME: P Cole
ADDRESS: College Crescent

Multiple sets of horizontal lines for additional text or signatures, mostly blank.

BLUE BELL 1 MAIN STREET HACKENTHORPE



OBJECTION TO PREMISES LICENCE.

I OBJECT TO THE APPLICATION FOR THE FOLLOWING REASONS.

THE PREMISES ARE ON A SMALL ROAD WITH LITTLE PARKING AND DOUBLE YELLOW LINES OUTSIDE, THE EXTRA PARKING AND DELIVERY TRAFFIC WILL CREATE A NUISANCE UNTIL LATE NIGHT FOR THE RESIDENTS AND BUSINESSES IN THE AREA, AND WILL ALSO BE A SAFETY ISSUE WITH PEDESTRIANS. UNDERAGE DRINKING HAS ALWAYS BEEN A PROBLEM IN THE AREA AND THIS APPLICATION WILL ONLY HELP TO EXACERBATE THIS.

NAME: Stacey Waite

ADDRESS: [REDACTED] Saddle Avenue
Waterthorpe S20 7LF

BLUE BELL 1 MAIN STREET HACKENTHORPE



OBJECTION TO PREMISES LICENCE.

I OBJECT TO THE APPLICATION FOR THE FOLLOWING REASONS.

THE PREMISES ARE ON A SMALL ROAD WITH LITTLE PARKING AND DOUBLE YELLOW LINES OUTSIDE, THE EXTRA PARKING AND DELIVERY TRAFFIC WILL CREATE A NUISANCE UNTIL LATE NIGHT FOR THE RESIDENTS AND BUSINESSES IN THE AREA, AND WILL ALSO BE A SAFETY ISSUE WITH PEDESTRIANS. UNDERAGE DRINKING HAS ALWAYS BEEN A PROBLEM IN THE AREA AND THIS APPLICATION WILL ONLY HELP TO EXACERBATE THIS.

NAME: SALLY BROCKLEHURST

ADDRESS: 101 HIGH RD, HACKENTHORPE

SHEFFIELD S10 4JY



BLUE BELL 1 MAIN STREET HACKENTHORPE



H

OBJECTION TO PREMISES LICENCE.

I OBJECT TO THE APPLICATION FOR THE FOLLOWING REASONS.

THE PREMISES ARE ON A SMALL ROAD WITH LITTLE PARKING AND DOUBLE YELLOW LINES OUTSIDE, THE EXTRA PARKING AND DELIVERY TRAFFIC WILL CREATE A NUISANCE UNTIL LATE NIGHT FOR THE RESIDENTS AND BUSINESSES IN THE AREA, AND WILL ALSO BE A SAFETY ISSUE WITH PEDESTRIANS. UNDERAGE DRINKING HAS ALWAYS BEEN A PROBLEM IN THE AREA AND THIS APPLICATION WILL ONLY HELP TO EXACERBATE THIS.

NAME: Mr Ian D Robertson
ADDRESS: [REDACTED] Birley Spa Drive
Sheffield S12 4BX

Multiple sets of horizontal lines for additional text or signatures, currently blank.



BLUE BELL 1 MAIN STREET HACKENTHORPE



OBJECTION TO PREMISES LICENCE.

I OBJECT TO THE APPLICATION FOR THE FOLLOWING REASONS.

THE PREMISES ARE ON A SMALL ROAD WITH LITTLE PARKING AND DOUBLE YELLOW LINES OUTSIDE, THE EXTRA PARKING AND DELIVERY TRAFFIC WILL CREATE A NUISANCE UNTIL LATE NIGHT FOR THE RESIDENTS AND BUSINESSES IN THE AREA, AND WILL ALSO BE A SAFETY ISSUE WITH PEDESTRIANS. UNDERAGE DRINKING HAS ALWAYS BEEN A PROBLEM IN THE AREA AND THIS APPLICATION WILL ONLY HELP TO EXACERBATE THIS.

NAME: Donna Martin

ADDRESS: Westland close S124PA

BLUE BELL 1 MAIN STREET HACKENTHORPE

OBJECTION TO PREMISES LICENCE.

I OBJECT TO THE APPLICATION FOR THE FOLLOWING REASONS.

THE PREMISES ARE ON A SMALL ROAD WITH LITTLE PARKING AND DOUBLE YELLOW LINES OUTSIDE, THE EXTRA PARKING AND DELIVERY TRAFFIC WILL CREATE A NUISANCE UNTIL LATE NIGHT FOR THE RESIDENTS AND BUSINESSES IN THE AREA, AND WILL ALSO BE A SAFETY ISSUE WITH PEDESTRIANS. UNDERAGE DRINKING HAS ALWAYS BEEN A PROBLEM IN THE AREA AND THIS APPLICATION WILL ONLY HELP TO EXACERBATE THIS.

NAME: MRS Smith

ADDRESS: Cotteragh Place
Hackenthorpe Sheffield S26 1AT

BLUE BELL 1 MAIN STREET HACKENTHORPE

OBJECTION TO PREMISES LICENCE.

I OBJECT TO THE APPLICATION FOR THE FOLLOWING REASONS.

THE PREMISES ARE ON A SMALL ROAD WITH LITTLE PARKING AND DOUBLE YELLOW LINES OUTSIDE, THE EXTRA PARKING AND DELIVERY TRAFFIC WILL CREATE A NUISANCE UNTIL LATE NIGHT FOR THE RESIDENTS AND BUSINESSES IN THE AREA, AND WILL ALSO BE A SAFETY ISSUE WITH PEDESTRIANS. UNDERAGE DRINKING HAS ALWAYS BEEN A PROBLEM IN THE AREA AND THIS APPLICATION WILL ONLY HELP TO EXACERBATE THIS.

NAME: GADSCY

ADDRESS: DEIGHTON

BLUE BELL 1 MAIN STREET HACKENTHORPE



OBJECTION TO PREMISES LICENCE.

I OBJECT TO THE APPLICATION FOR THE FOLLOWING REASONS.

THE PREMISES ARE ON A SMALL ROAD WITH LITTLE PARKING AND DOUBLE YELLOW LINES OUTSIDE, THE EXTRA PARKING AND DELIVERY TRAFFIC WILL CREATE A NUISANCE UNTIL LATE NIGHT FOR THE RESIDENTS AND BUSINESSES IN THE AREA, AND WILL ALSO BE A SAFETY ISSUE WITH PEDESTRIANS. UNDERAGE DRINKING HAS ALWAYS BEEN A PROBLEM IN THE AREA AND THIS APPLICATION WILL ONLY HELP TO EXACERBATE THIS.

NAME: E. WALKER

ADDRESS: [REDACTED] CARTER LODGE AVE S. 2
E. Walker





BLUE BELL 1 MAIN STREET HACKENTHORPE

OBJECTION TO PREMISES LICENCE.

I OBJECT TO THE APPLICATION FOR THE FOLLOWING REASONS.

THE PREMISES ARE ON A SMALL ROAD WITH LITTLE PARKING AND DOUBLE YELLOW LINES OUTSIDE, THE EXTRA PARKING AND DELIVERY TRAFFIC WILL CREATE A NUISANCE UNTIL LATE NIGHT FOR THE RESIDENTS AND BUSINESSES IN THE AREA, AND WILL ALSO BE A SAFETY ISSUE WITH PEDESTRIANS. UNDERAGE DRINKING HAS ALWAYS BEEN A PROBLEM IN THE AREA AND THIS APPLICATION WILL ONLY HELP TO EXACERBATE THIS.

NAME: Rebecca Baldwin

ADDRESS: [REDACTED] Jemyn Avenue

BLUE BELL 1 MAIN STREET HACKENTHORPE



OBJECTION TO PREMISES LICENCE.

I OBJECT TO THE APPLICATION FOR THE FOLLOWING REASONS.

THE PREMISES ARE ON A SMALL ROAD WITH LITTLE PARKING AND DOUBLE YELLOW LINES OUTSIDE, THE EXTRA PARKING AND DELIVERY TRAFFIC WILL CREATE A NUISANCE UNTIL LATE NIGHT FOR THE RESIDENTS AND BUSINESSES IN THE AREA, AND WILL ALSO BE A SAFETY ISSUE WITH PEDESTRIANS. UNDERAGE DRINKING HAS ALWAYS BEEN A PROBLEM IN THE AREA AND THIS APPLICATION WILL ONLY HELP TO EXACERBATE THIS.

NAME: Nicole

ADDRESS: [REDACTED] Delves road

Hackenthorpe

BLUE BELL 1 MAIN STREET HACKENTHORPE

OBJECTION TO PREMISES LICENCE.

I OBJECT TO THE APPLICATION FOR THE FOLLOWING REASONS.

THE PREMISES ARE ON A SMALL ROAD WITH LITTLE PARKING AND DOUBLE YELLOW LINES OUTSIDE, THE EXTRA PARKING AND DELIVERY TRAFFIC WILL CREATE A NUISANCE UNTIL LATE NIGHT FOR THE RESIDENTS AND BUSINESSES IN THE AREA, AND WILL ALSO BE A SAFETY ISSUE WITH PEDESTRIANS. UNDERAGE DRINKING HAS ALWAYS BEEN A PROBLEM IN THE AREA AND THIS APPLICATION WILL ONLY HELP TO EXACERBATE THIS.

NAME: Mrs M. Allen

ADDRESS: [REDACTED] Colleigh Road
Hackenthorpe Sheffield S12

BLUE BELL 1 MAIN STREET HACKENTHORPE

OBJECTION TO PREMISES LICENCE.

I OBJECT TO THE APPLICATION FOR THE FOLLOWING REASONS.

THE PREMISES ARE ON A SMALL ROAD WITH LITTLE PARKING AND DOUBLE YELLOW LINES OUTSIDE, THE EXTRA PARKING AND DELIVERY TRAFFIC WILL CREATE A NUISANCE UNTIL LATE NIGHT FOR THE RESIDENTS AND BUSINESSES IN THE AREA, AND WILL ALSO BE A SAFETY ISSUE WITH PEDESTRIANS. UNDERAGE DRINKING HAS ALWAYS BEEN A PROBLEM IN THE AREA AND THIS APPLICATION WILL ONLY HELP TO EXACERBATE THIS.

NAME: MRS. C. Brummett

ADDRESS: [REDACTED] Carr Forge Rd
S19 4FJ

BLUE BELL 1 MAIN STREET HACKENTHORPE



OBJECTION TO PREMISES LICENCE.

I OBJECT TO THE APPLICATION FOR THE FOLLOWING REASONS.

THE PREMISES ARE ON A SMALL ROAD WITH LITTLE PARKING AND DOUBLE YELLOW LINES OUTSIDE, THE EXTRA PARKING AND DELIVERY TRAFFIC WILL CREATE A NUISANCE UNTIL LATE NIGHT FOR THE RESIDENTS AND BUSINESSES IN THE AREA, AND WILL ALSO BE A SAFETY ISSUE WITH PEDESTRIANS. UNDERAGE DRINKING HAS ALWAYS BEEN A PROBLEM IN THE AREA AND THIS APPLICATION WILL ONLY HELP TO EXACERBATE THIS.

NAME: LISA DAVIS

ADDRESS: [REDACTED] CARTER LODGE AVE



BLUE BELL 1 MAIN STREET HACKENTHORPE

OBJECTION TO PREMISES LICENCE.

I OBJECT TO THE APPLICATION FOR THE FOLLOWING REASONS.

THE PREMISES ARE ON A SMALL ROAD WITH LITTLE PARKING AND DOUBLE YELLOW LINES OUTSIDE, THE EXTRA PARKING AND DELIVERY TRAFFIC WILL CREATE A NUISANCE UNTIL LATE NIGHT FOR THE RESIDENTS AND BUSINESSES IN THE AREA, AND WILL ALSO BE A SAFETY ISSUE WITH PEDESTRIANS. UNDERAGE DRINKING HAS ALWAYS BEEN A PROBLEM IN THE AREA AND THIS APPLICATION WILL ONLY HELP TO EXACERBATE THIS.

NAME: BELL

ADDRESS: [REDACTED] CARTER LODGE AVE

Appendix 'C'

**Notice of hearing of representations
in respect of the following application:
LA03 Premises Licence Application**

Mr Hardial Singh Mahal
Post Office
Gunhill
New Arley
Warwickshire
CV7 8HB

The Sheffield City Council being the licensing authority, on the **5 October 2012** received your application in respect of the premises known as **Blue Bell Inn, 1 Main Street, Sheffield, S12 4LA**.

During the consultation period, the Council received representations from the following:

- Local residents

on the likely effect of this application on the promotion of the licensing objectives, should it be granted.

The Council now **GIVES YOU NOTICE** that representations will be considered at a hearing to be held in a meeting room at Sheffield City Council, The Town Hall, Pinstone Street, Sheffield S1 2HH, on the **13 December 2012 at 10am**; following which the Council will issue a notice of determination of the application.

The documents which accompany this notice are the relevant representations which have been made, as defined in Section 35(5) of the Act.

The particular points on which the Council considers that it will want clarification at the hearing from a party are as follows:

- 1) Your response to the representations made, upon which you may ask and be asked questions by the parties to the hearing.
- 2) You may also be asked questions by the parties to the hearing, relating to your application for a licence.

Please complete the attached form LAR1 and return it to: **Licensing Service, Sheffield City Council, Block C Staniforth Road Depot, Staniforth Road, Sheffield, S9 3HD** within five (5) working days before the day or the first day on which the hearing is to be held.

Dated: 26/11/12

Signed: 

The officer appointed for this purpose
Licensing Officer

Please address any communications to: Licensing Service, Sheffield City Council, Block C Staniforth Road Depot Staniforth Road Sheffield S9 3HD.



**Notice of hearing of representations
in respect of the following application:
LA03_Premises Licence Application**

The Objector

The Sheffield City Council being the licensing authority, on the **5 October 2012** received an application in respect of the premises known as **Blue Bell Inn, 1 Main Street, Sheffield, S12 4LA**.

During the consultation period, the Council received representations from the following:

- Local residents

on the likely effect of this application on the promotion of the licensing objectives, should it be granted.

The Council now **GIVES YOU NOTICE** that representations will be considered at a hearing to be held in a meeting room at Sheffield City Council, The Town Hall, Pinstone Street, Sheffield S1 2HH, on the **13 December 2012 at 10am**; following which the Council will issue a notice of determination of the application.

The particular points on which the Council considers that it will want clarification at the hearing from a party are as follows:

- 1) The representations you have made with reference to these particular premises and the four core objectives.
- 2) You may also be asked questions by the parties to the hearing, relating to your representations.

Please complete the attached form LAR1 and return it to: **Licensing Service, Sheffield City Council, Block C, Staniforth Road Depot, Staniforth Road, Sheffield, S9 3HD, within (5) working days before the day or the first day on which the hearing is to be held.**

Dated: 26/11/12

Signed: 

The officer appointed for this purpose
Licensing Officer

Please address any communications to: Licensing Service, Sheffield City Council Block C, Staniforth Road Depot Staniforth Road Sheffield S9 3HD.

Appendix 'D'

**Notice of hearing of representations
in respect of the following application:
LA03 Premises Licence Application**

Mr Hardial Singh Mahal
Post Office
Gunhill
New Arley
Warwickshire
CV7 8HB

The Sheffield City Council being the licensing authority, on the **5 October 2012** received your application in respect of the premises known as **Blue Bell Inn, 1 Main Street, Sheffield, S12 4LA**.

During the consultation period, the Council received representations from the following:

- Local residents

on the likely effect of this application on the promotion of the licensing objectives, should it be granted.

The Council now **GIVES YOU NOTICE** that representations will be considered at a hearing to be held in a meeting room at Sheffield City Council, The Town Hall, Pinstone Street, Sheffield S1 2HH, on the **13 December 2012 at 10am**; following which the Council will issue a notice of determination of the application.

The documents which accompany this notice are the relevant representations which have been made, as defined in Section 35(5) of the Act.

The particular points on which the Council considers that it will want clarification at the hearing from a party are as follows:

- 1) Your response to the representations made, upon which you may ask and be asked questions by the parties to the hearing.
- 2) You may also be asked questions by the parties to the hearing, relating to your application for a licence.

Please complete the attached form LAR1 and return it to: **Licensing Service, Sheffield City Council, Block C Staniforth Road Depot, Staniforth Road, Sheffield, S9 3HD** within five (5) working days before the day or the first day on which the hearing is to be held.

Dated: 26/11/12

Signed: 

The officer appointed for this purpose
Licensing Officer

Please address any communications to: Licensing Service, Sheffield City Council, Block C Staniforth Road Depot Staniforth Road Sheffield S9 3HD.

Right of attendance, assistance and representation

15. Subject to regulations 14(2) and 25, a party may attend the hearing and may be assisted or represented by any person whether or not that person is legally qualified.

Representations and supporting information

16. At the hearing a party shall be entitled to –
- (a) in response to a point upon which the authority has given notice to a party that it will want clarification under regulation 7(1)(d), give further information in support of their application, representations or notice (as applicable),
 - (b) if given permission by the authority, question any other party; and
 - (c) address the authority

Failure of parties to attend the hearing

20. – (1) If a party has informed the authority that he does not intend to attend or be represented at a hearing, the hearing may proceed in his absence.
- (2) If a party who has not so indicated fails to attend or be represented at a hearing the authority may:–
- (a) where it considers it to be necessary in the public interest, adjourn the hearing to a specified date, or
 - (b) hold the hearing in the party's absence.
- (3) Where the authority holds the hearing in the absence of a party, the authority shall consider at the hearing the application, representations or notice made by that party.
- (4) Where the authority adjourns the hearing to a specified date it must forthwith notify the parties of the date, time and place to which the hearing has been adjourned.

Procedure at hearing

21. Subject to the provisions of the Regulations, the authority shall determine the procedure to be followed at the hearing.
22. At the beginning of the hearing, the authority shall explain to the parties the procedure which it proposes to follow at the hearing and shall consider any request made by a party under regulation 8(2) for permission for another person to appear at the hearing, such permission shall not be unreasonably withheld.
23. A hearing shall take the form of a discussion led by the authority and cross-examination shall not be permitted unless the authority considers that cross-examination is required for it to consider the representations, application or notice as the case may require.
24. The authority must allow the parties an equal maximum period of time in which to exercise their rights provided for at regulation 16.
25. The authority may require any person attending the hearing who in their opinion is behaving in a disruptive manner to leave the hearing and may –
- (a) refuse to permit that person to return, or
 - (b) permit him to return only on such conditions as the authority may specify, but such a person may, before the end of the hearing, submit to the authority in writing any information which they would have been entitled to give orally had they not been required to leave.

y



Licensing Act 2003 – Hearing Procedure – Regulation 7 (1)

This procedure has been drawn up in accordance with the Licensing Act 2003 to assist those parties attending Licensing Committee hearings.

1. The hearing before the Council is Quasi Judicial.
2. The Chair of the Licensing Committee will introduce the Committee and ask officers to introduce themselves.
3. The Chair will ask the applicants to formally introduce themselves.
4. The Solicitor to the Committee will outline the procedure to be followed at the hearing.
5. Hearing Procedure:-
 - (a) The Licensing Officer will introduce the report.
 - (b) Questions concerning the report can be asked both by Members and the applicant.
 - (c) The Licensing Officer will introduce in turn representatives for the Responsible Authority and Interested Parties who will be asked to detail their relevant representations.
 - (d) Members may ask questions of those parties
 - (e) With the leave of the Chair the applicant or his representative may cross examine the representatives of the Responsible Authorities and Interested Parties.
 - (f) The applicant/licensee (or his/her nominated representative) will then be asked to:-
 - (i) detail the application;
 - (ii) provide clarification on the application and respond to the representations made.
 - (g) The applicant/licensee (or his/her nominated representative) may then be asked questions by members and with the leave of the Chair from the other parties present.
 - (h) The applicant will then be given the opportunity to sum up the application.
 - (i) The Licensing Officer will then detail the options.
 - (j) There will then be a private session for members to take legal advice and consider the application.
6. The decision of the Licensing Committee will be given in accordance with the requirements of the Licensing Act 2003 and regulations made there under.

- NB:
- 1) At any time in the Licensing Process Members of the Committee may request legal advice from the Solicitor to the Committee. This advice may be given in open session or in private.
 - 2) The Committee Hearing will be held in public unless and in accordance with the Regulations the Committee determine that the public should be excluded.

LICENSING ACT 2003

Premises: Blue Bell Inn
Type of App: LA03_Premises Licence Application
Hearing Date: 13 December 2012

Form LAR 1
Regulation 8



Notice of actions following receipt of notice of hearing

To **Licensing Service,
Sheffield City Council
Block C Staniforth Road Depot
Staniforth Road
Sheffield
S9 3HD**

I **Mr Hardial Singh Mahal**

Of **Post Office
Gunhill
New Arley
Warwickshire
CV7 8HB**

hereby confirm that I have received the Notice of Hearing dated and notify you as follows
(please complete):

- I intend to attend the hearing
- I do not intend to attend the hearing
- I intend to be represented at the hearing by:
- I do not intend to be represented at the hearing by:
- I consider the hearing to be unnecessary because:
- I request thatshould appear at the hearing and set out below the point or points on which this person may be able to assist the authority in relation to this application, representations or notice of the party making the request.

Dated: Signed:

Please see Regulation 8 overleaf

Please complete this form and return it to:
Licensing Service, Sheffield City Council, Block C Staniforth Road Depot, Staniforth Road, Sheffield, S9 3HD.

Regulation 8

- (1) A party shall give to the authority within the period of time provided for in the following provisions of this regulation a notice stating –
- (a) whether he intends to attend or be represented at the hearing;
 - (b) whether he considers a hearing to be unnecessary
- (2) In a case where a party wishes any other person (other than the person he intends to represent him at the hearing) to appear at the hearing, the notice referred to in paragraph (1) shall contain a request for permission for such other person to appear at the hearing accompanied by details of the name of that person and a brief description of the point or points on which that person may be able to assist the authority in relation to the application, representations or notice of the party making the request.
- (3) In the case of a hearing under –
- (a) section 48(3)(a) (cancellation of interim authority notice following police objection), or
 - (b) section 105(2)(a) (counter notice following police objection to temporary event notice),

the party shall give the notice no later than one working day before the day or the first day on which the hearing is to be held.

- (4) In the case of a hearing under –
- (a) section 167(5)(a) (review of premises licence following closure order),
 - (b) paragraph 4(3)(a) of Schedule 8 (determination of application for conversion of existing licence), paragraph 16(3)(a) of Schedule 8 (determination of application for conversion of existing club certificate)
 - (c) paragraph 26(3)(a) of Schedule 8 (determination of application by holder of justices' licence for grant of personal licence),

the party shall give the notice no later than two working days before the day or the first day on which the hearing is to be held.

- (5) In any other case, the party shall give the notice no later than five working days before the day or the first day on which the hearing is to be held.